

Job Name		Engineer / Architect	
Job Location		Wholesaler	
Submittal Date		Contractor	

DRS44MX Integral Shut-Off Straight Stop w/ Lock Shield & Screwdriver Slot – Female Sweat x Male Sweat

Use: For use in potable water distribution systems in accessible locations only. Not intended for recirculating water systems that produce continuous use temperatures above 115° F. For those applications use our KT™ series ball stop.

Design Features:

- **Machined one-piece brass body** provides strength, durability and long-lasting performance
- **Screwdriver slot handle** helps protect against accidental stop operation during rough-ins and in general use



Operating Specifications:

Temperature: 40° - 160° F
Pressure: 125 PSI maximum

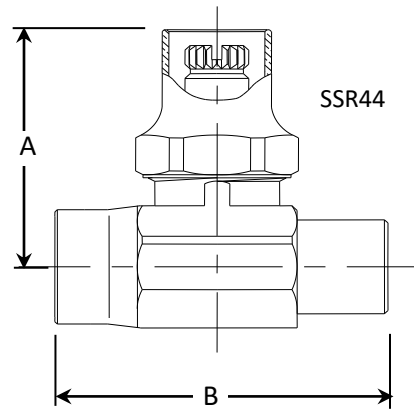
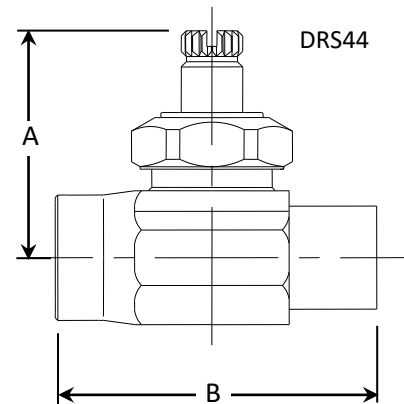

STOP MATERIAL SPECIFICATIONS

Body	Brass
Screwdriver Slot Stem	Brass
Bib & Packing Washer	Rubber
Packing Nut	Brass

PART DIMENSIONS (Inches)

Model	DIM. A	DIM. B
DRS44MX	1.41	1.94
SSR44MX	1.54	1.94

Part Listing:

- DRS44MX R 1/2" nom female sweat x 1/2" nom male sweat w/ screwdriver slot, rough brass
- DRS44MX R1 1/2" nom female sweat x 1/2" nom male sweat w/ screwdriver slot, rough brass, window tray
- SSR44MX C 1/2" nom female sweat x 1/2" nom male sweat w/ lock shield, chrome
- SSR44MX R 1/2" nom female sweat x 1/2" nom male sweat w/ lock shield, rough brass

Listings & Certifications:

- IAPMO listed to ASME A112.18.1 /CSA B125.1 (includes NSF/ANSI372& NSF61)



This specification and all information contained herein is the confidential and exclusive property of BrassCraft Manufacturing Company and shall not be disclosed to others without the written consent of BrassCraft. This specification must be returned to BrassCraft if requested.

BrassCraft®