

# 7000 SERIES SPECIFICATIONS

## designer blu-stone™ bathtubs

BT7000 | BT7010 | BT7020 | BT7030 | BT7040 | BT7050 | BT7060 | BT7070 | BT7080

### BATHTUB FEATURES:

- Base bathwell + custom side(s) make up each model
- Can be freestanding, alcove or recessed
- Streamlined, high profile one piece bathtub design
- Made of blu-stone™, providing the look and feel of natural stone
- Stronger and more durable than acrylic
- Non-porous, stain resistant surface that does not require sealing
- Does not promote bacteria, mold or fungi
- Includes integral slot overflow & polished chrome waste cover
- Extended side deck areas - suitable for deckmount faucet installation
- Versatile left-hand or right-hand drain installation
- Alcove installation requires separate tile flange, not included.  
(Blu recommends TF.BTSB tile flange)
- Tailpiece not included. (Blu recommends BTWaste.RN or BTWasteCI.RN)



Model shown: BT7010

### BATHTUB SPECIFICATIONS:

Basin Area:	65" (1650mm) x 25½" (650mm)*
Top Area:	<b>MAX:</b> 86½" (2200mm) x 43¼" (1100mm)* <b>MIN:</b> 70¾" (1800mm) x 31½" (800mm)*
To Overflow:	2½" (65mm)*
Water Depth:	14¼" (360mm)*
Capacity:	85G (322L)*
Slope of Backrest:	47°*
Hot water supply req'd:	Should be 70% of water capacity of tub or greater
Warranty:	Five Year Warranty (Residential use) One Year Warranty (Commercial use)
Material:	blu-stone™

### BATHTUB FINISH:

White Matte

### ACCESSORIES (sold separately):

- TF.BTSB tile flange for alcove installation
- BTWaste.RN or BTWasteCI.RN Island tub drain for easy installation

### INSTALLATION NOTES:

Install this product according to the installation guide. Floor support under bath must provide for a minimum of 1400 lbs (635kg). Installation will vary. Our products must be installed by certified professionals only and according to our installation guide as well as federal, provincial / state a local building codes and regulations

### CODES / STANDARDS APPLICABLE:

- Meets or exceeds ANSI / ASME standard  
CSA B45.5.11 / IAPMO Z124
- IAPMO / ANSI Z124.8
- CSA

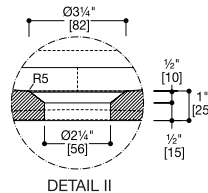
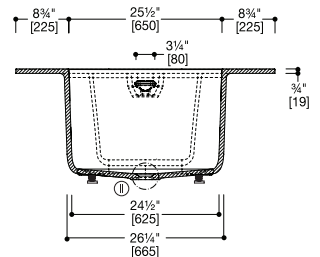
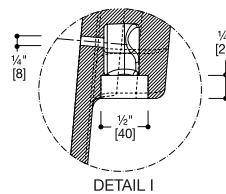
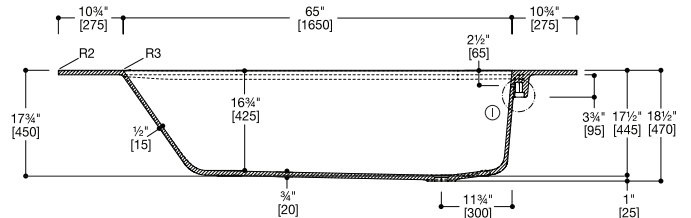
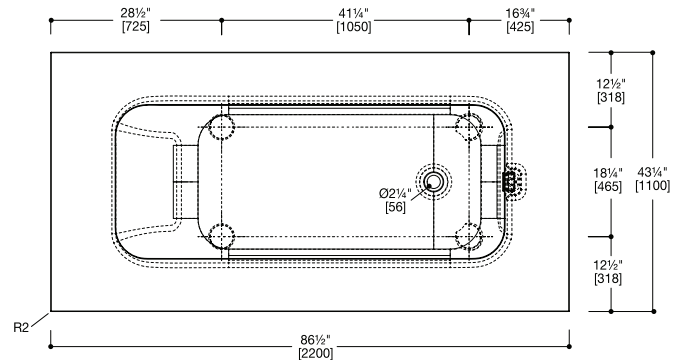

\*Approximate measurements for comparison only.  
Note: These dimensions and specifications are subject to change without notice.

# 7000 SERIES SPECIFICATIONS

## designer blu-stone™ bathtubs

BT7000 | BT7010 | BT7020 | BT7030 | BT7040 | BT7050 | BT7060 | BT7070 | BT7080

Please use order templates found at [blubathworks.com](http://blubathworks.com) to assist in placing your order.

**BT7000**

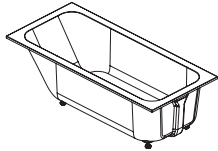

- Base unit
- No sides

**BT7050-01M**

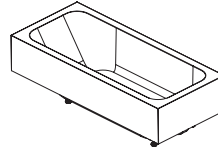

- Floor recessed
- 4 custom sides

**BT7010**

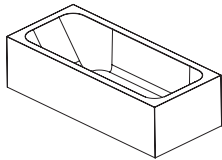

- Freestanding
- Finished 4 sides

**BT7060**

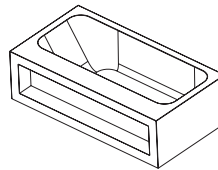

- Library A
- 1 front shelving unit  
+ 2 sides + 1 end

**BT7020**

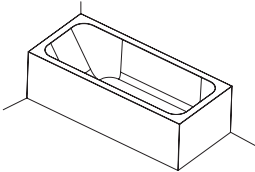

- Corner
- 1 front + 1 end

**BT7070**

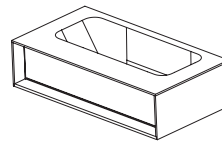

- Library B
- 1 front shelving unit  
+ 2 sides + 1 end

**BT7030**

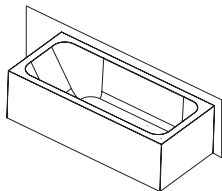

- Wall
- 1 front + 2 ends

**BT7080**

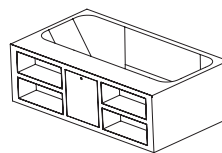

- Library C
- 1 front shelving unit  
+ 2 sides + 1 end
- Includes magnetic door (BTDoor)

**BT7040**

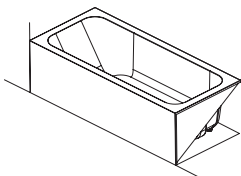

- Niche
- 1 front