

BT6100 SPECIFICATIONS

amanpuri-1 blu-stone™ bathtub with recessed shelving

BATHTUB FEATURES:

- Seamless, one-piece blu-stone™ bathtub with 3-sided apron
- Suitable for freestanding or alcove installation
- 71 3/4" L x 37 3/4" W x 21 3/4" H
- Deep soaking tub, with 85 gallon (320L) capacity
- Includes integral slot overflow & matching blu-stone™ waste cover
- Left drain installation as standard
- Right drain installation available (Tier 1 item: BT6100R)
- Adjustable levelling feet
- Extended front deck area - suitable for deck-mount faucet installation
- Made of blu-stone™, providing the look and feel of natural stone
- Stronger and more durable than acrylic
- Non-porous, stain resistant surface that does not require sealing
- Does not promote bacteria, mold or fungi
- Designed for modular recessed shelving, with a choice of 51 collection
- Hard Surface Technology (HST) or White Matte lacquer finish
- Vanities & mirrors are available in coordinating finishes
- Alcove installation requires separate tile flange (recommend TF.BTSB tile flange, sold separately)
- Blu recommends Island tub drain for easy installation of freestanding tubs (BTWaste.RN or BTWasteCl.RN, sold separately)

BATHTUB SPECIFICATIONS:

Basin Area:	65" (1650mm) x 25 1/2" (650mm)*
Top Area:	71 3/4" (1820mm) x 37 3/4" (960mm)*
To Overflow:	2 1/2" (65mm)*
Water Depth:	15" (380mm)*
Capacity:	85G (320L)*
Slope of Backrest:	47°*
Weight:	454lbs (206kg)*
Hot water supply req'd:	Should be 70% of water capacity of tub or greater
Warranty:	Five Year Warranty (Residential use) One Year Warranty (Commercial use)
Material:	blu-stone™
Shipping Weight:	586lbs (266kg)*
Shipping Dimensions:	(LWH) 74 1/2" x 40 1/2" x 22 3/4" (1890mm x 1030mm x 580mm)*

BATHTUB FINISH:
White Matte

INSTALLATION NOTES:

Install this product according to the installation guide. Floor support under bath must provide for a minimum of 1400 lbs (635kg). Installation will vary. Our products must be installed by certified professionals only and according to our installation guide as well as federal, provincial / state a local building codes and regulations.

CODES / STANDARDS APPLICABLE:

- Meets or exceeds ANSI / ASME standard
CSA B45.5.11 / IAPMO Z124
- IAPMO / ANSI Z124.8
- CSA



*Approximate measurements for comparison only.

Note: These dimensions and specifications are subject to change without notice.

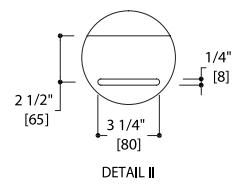
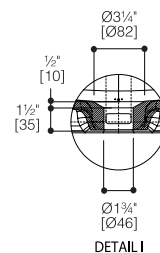
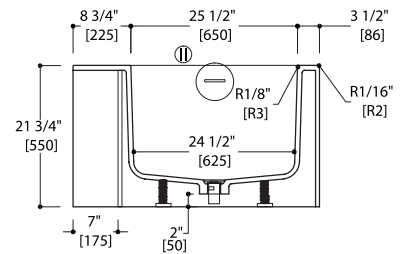
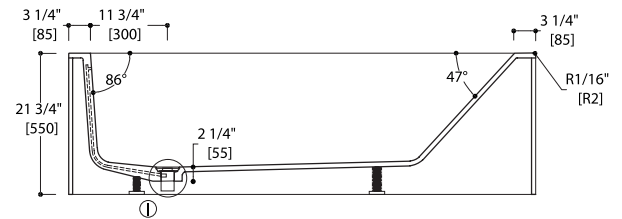
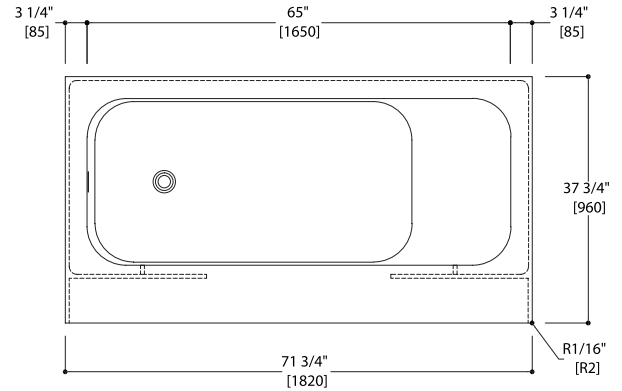

BT6100 SPECIFICATIONS

amanpuri-1 blu-stone™ bathtub with recessed shelving

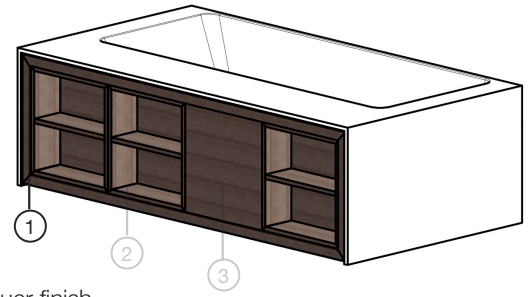

RECESSED SHELVING FEATURES:

- Sustainably crafted with non-VOC material with the lowest formaldehyde emissions
- Water repellent wood fiber panels also ensure defence against humidity
- Available in a range of 51 collection Hard Surface Technology (HST) or White Matte lacquer finish

FURNITURE SPECIFICATIONS:

- 1: BT6101 Master Shell - (LWH) 70" (1778mm) x 6¾" (170mm) x 20¼" (517mm)*
- 2: BT6102 Shelving Unit - (LWH) 16¾" (424) x 5½" (143mm) x 17¼" (437mm)*
- 3: BT6105 Deck-mount Faucet Cover - (LWH) 16¾" (424mm) x 5½" (143mm) x 17¼" (437mm)*

Warranty: Five Year Warranty (Residential use)
One Year Warranty (Commercial use)

Material: Hard Surface Technology (HST) & Lacquer

SHELVING FINISHES:

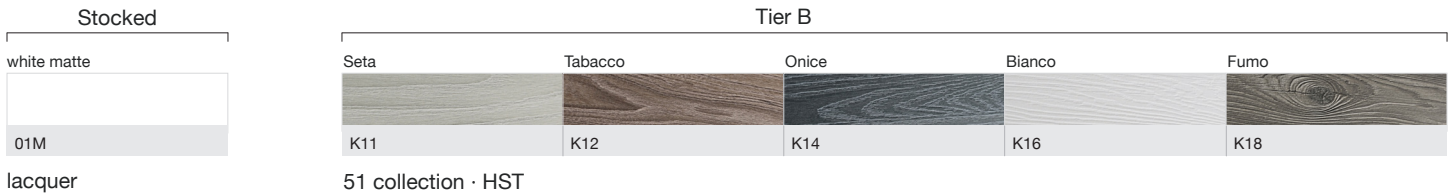

① BT6101 master shell

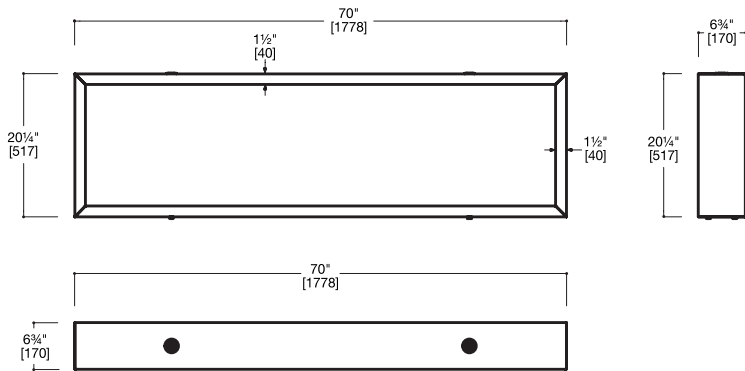

BT6100 SPECIFICATIONS

amanpuri-1 blu-stone™ bathtub with recessed shelving

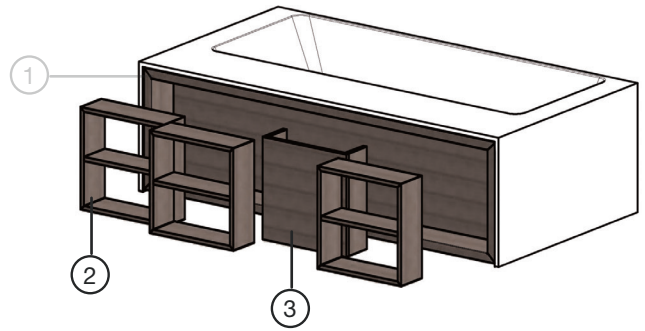

② BT6102 shelving unit

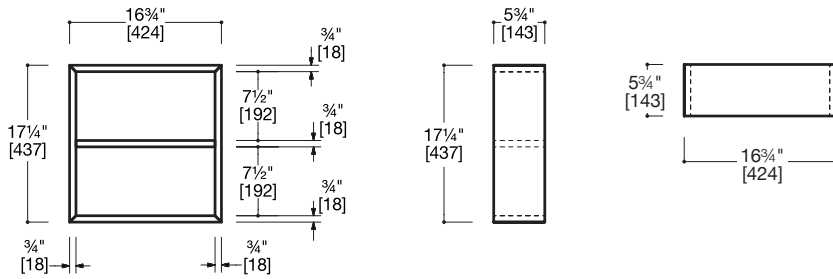

③ BT6105 deck-mount faucet cover

