

blu·stone™ vanity countertop Installation Guide

SAC0600



SAC1200



SAC0700



SAC1400



SAC0900



SAC1800



SAC2700



Attention — Before Installation

- We recommend that the installation be done by a minimum of 2 people as a security precaution. Also make sure to adopt the proper posture when lifting the countertop.
- Adhere to all local building and plumbing codes. The diagrams in this guide are not construction plans. They are visual aids.
- For best results, the floor must be level and the wall must be square with the floor.

Installation Requirements

Please read the instructions carefully so as to avoid any damage to the fixture.

1. To ensure this product is installed properly, you must read and follow these guidelines.
2. The owner/user of the product must keep this information for future reference.
3. Consult local building codes to make sure the installation complies with standards.
4. Remove the unit from its packaging. Before disposing of it, inspect the unit to make sure its in good shape. Should inspection reveal any damage or defect in the finish, contact your distributor. The warranty does not cover damages or defects in the finish once it has been installed. Blu Bathworks' responsibility for shipping damages ceases upon delivery of the product in good order to the carrier. All complaints regarding damage due to transport must be made directly to the carrier.
5. Place the unit in the bathroom before you start working. Conserve all nuts and bolts.
6. To protect the unit during installation, we recommend that you lay a piece of cardboard on the bottom.
7. If the unit is covered with polyethylene protective film, do not remove until installation is complete to grant maximum protection. However, remove film where any two surfaces will be in permanent contact.
8. Verify that all dimensions on the plan are the same as the ones of the unit.

Installation Notes

Important! Install this product according to the installation guide. Product does have an overflow. Spout must provide a minimum of 5" reach for adequate clearance into basin. Our products must be installed by certified professionals only and according to our installation guide as well as federal, provincial / state and local building codes and regulations.

Tools Required

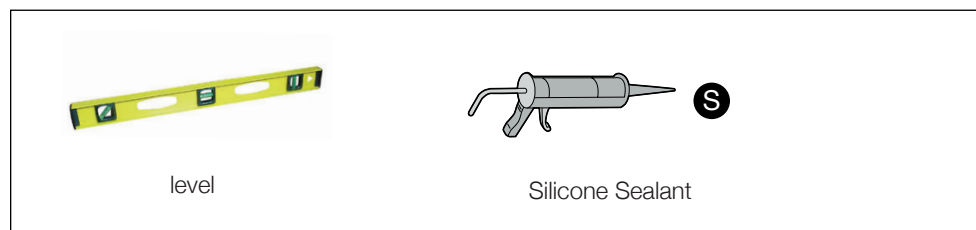

Technical Support Assistance

If further assistance is required, please contact:

Product Support at 1.866.907.0122 (09:00 – 17:00hrs PST) or email technical@blubathworks.com

North America

Blu Bathworks Inc.
188 Smithe Street, Vancouver, BC, Canada, V6B 6A9
T +1.604.299.0122 F +1.604.299.0125

Please refer to blubathworks.com for warranty, terms & conditions under warranty & procedure for warranty service.

Installation Notes

Important! Install this product according to the installation guide. Our products must be installed by certified professionals only and according to our installation guide as well as federal, provincial / state and local building codes and regulations.

Installation for Vanity Countertop

COUNTERTOP INSTALLATION

***Note: For drain and deck mounted tapware refer to drilling instructions prior to the installation of the countertop.**

1. Apply a ¼" (6mm) continuous bead of silicone sealant around the top of the vanity, as illustrated.
2. Position the countertop on top of the vanity.
3. Verify that the countertop is level. If the countertop is not level, gently press down on the countertop.
4. Wipe away excess silicone sealant.
5. Allow the silicone sealant to set according to the sealant manufacturer's instructions.

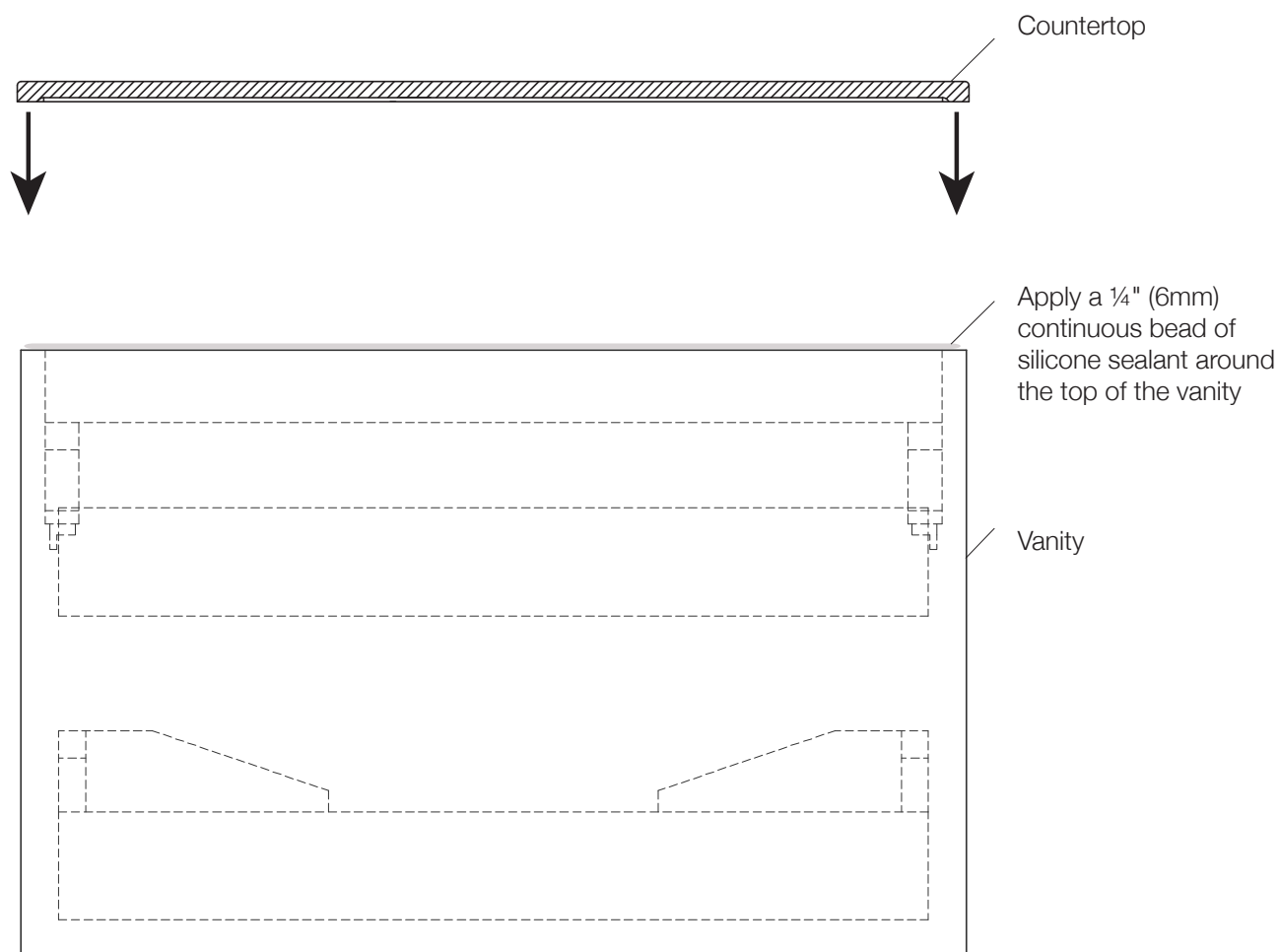

Faucet and Drain Connections (Not Supplied)

- Connect the water supply to the faucet according to faucet instructions.
- Connect and tighten the overflow system.
- Connect and tighten the trap to the drain.
- Turn ON the water supplies to the faucet.
- Purge air from the HOT & COLD water by running the water for a few seconds.
- Fill the installed basin with water.
- Check for leaks at the water supply and drain connections.

Drilling Instructions for Deck Mount Faucets and Drain

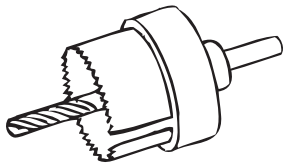

- Use a WIDIA (Cemented Carbide) cutter with the appropriate diameter according to the faucet manufacturer's installation guide.
- Start drilling from the underside of the countertop.
- Applying light pressure, drill and stop when the center drill has completely penetrated the countertop.
- Remove the cutter and flip the countertop over.
- Place the cutter into the guide hole.
- Applying light pressure, finish drilling the required hole.