

# 69" LIVINGSTONE ACRYLIC SLIPPER TUB

Cat. No.  
ATSN68LP



L: 69"  
W: 29-1/4"  
H: 25-3/4" - 30-1/4"

Water depth: 16-1/4" to top of tub

**The following is recommended for ATSN68LP tubs:**

- Faucets: part #4602, 4022, and 4025
- Rigid, freestanding supplies: part #4502
- Leg tub drain: part #5599LT or 5599TS

Gallon Capacity: 57  
Shipping Weight: 144 lbs.  
Empty Weight: 84 lbs.  
Filled Weight: 626 lbs.



Overflow can be drilled.  
With overflow drilled this tub requires drain 5599PD.  
**Tubs that have been drilled with overflow are "special order" and are not returnable.**

## Features:

- ▶ Acrylic construction for lighter weight
- ▶ Space between walls partially filled with fiberglass & resin
- ▶ No faucet holes
- ▶ No overflow
- ▶ Built-in adjusters included
- ▶ Aluminum lion paw feet available in 4 finishes
- ▶ Tub is thoroughly inspected before shipment
- ▶ IAPMO Certified



## Feet Finishes:

- BN** Brushed Nickel
- CP** Polished Chrome
- PB** Polished Brass
- ORB** Oil Rubbed Bronze

**Custom Colors Available** (inside of tub is always white enamel):  
Painted bathtubs are considered "special order" and are not returnable  
\$160 Bisque or Black \$250 Designer Color

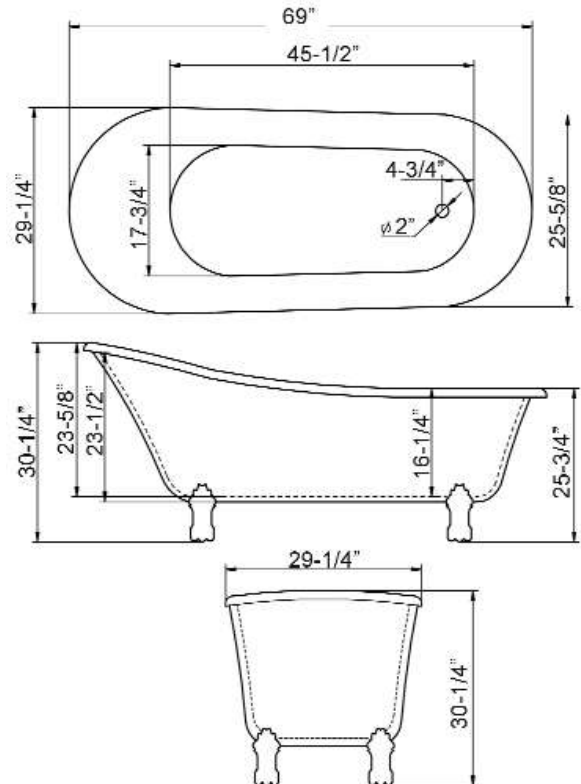

Dimensions of fixture are nominal and specifications subject to change without notice.