

**68" GITALI  
SINGLE SLIPPER  
COPPER TUB**

Cat. No.  
COTSN68



L: 67-1/2"  
W: 31-1/2"  
H: 29-5/8"

Rim: 2 1/2 W  
Water depth: 17" to top of tub

**The following is recommended for COTDS  
tubs without faucet holes:**

- Faucet: part #7082 or 7088
- Double offset supplies: part #4502 or 4502MC
- Freestanding filler:  
part #7901, 7913, 7922 or 7952  
(Supplies included with filler)



Overflow can be drilled.  
With overflow drilled this tub  
requires drain 5599 E.  
**Tubs that have been  
drilled with overflow are  
"special order" and  
are not returnable.**

Gallon Capacity: 78  
Shipping Weight: 210 lbs.  
Empty Weight: 104 lbs.  
Filled Weight: 751 lbs.

**Features:**

- ▶ Single slipper
- ▶ Copper claw feet
- ▶ Constructed of 16 gauge copper  
(Copper is a living finish and will patina over time)
- ▶ Hammered antique copper exterior and shiny interior
- ▶ Smooth rim: 2-1/2"
- ▶ Foot Leg Height: 5-5/8"
- ▶ No faucet holes
- ▶ No overflow
- ▶ Hand-crafted construction makes each tub unique

**Tub Finish:**

**AC** Hammered Antique Copper

Due to the handmade nature of this product, variations in size and finish may occur. Such variations do not constitute manufacturer defects.

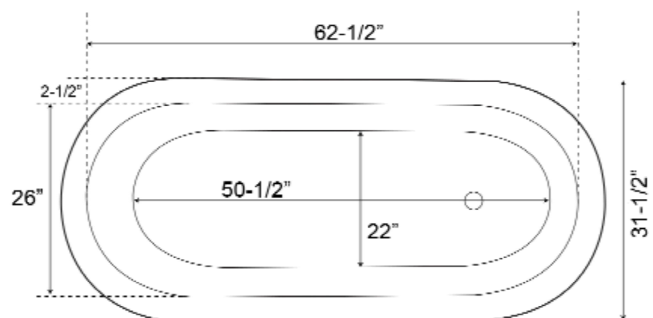
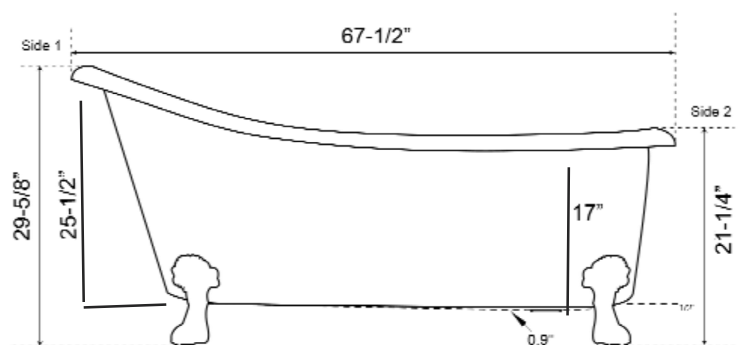

Dimensions and specifications subject to change without notice.