

**LAWSON  
66" COPPER  
SLIPPER TUB**

Cat. No.  
COTSN66-LC-PB



L: 66-1/2"  
W: 32-1/8"  
H: 23-1/4" to 32"

Rim: 2-1/2" W  
Overflow hole: 2"  
Water depth: 18-3/8" to top of tub

**The following is recommended for COTDS tubs without faucet holes:**

- Faucet: part #7082 or 7088
- Double offset supplies: part #4502 or 4502MC
- Freestanding filler: part #7901, 7913, 7922 or 7952 (Supplies included with filler)



Overflow can be drilled.  
With overflow drilled this tub requires drain 5599E.  
**Tubs that have been drilled with overflow are "special order" and are not returnable.**

Gallon Capacity : 68  
Shipping Weight: 186 lbs.  
Empty Weight: 99 lbs.  
Filled Weight: 663 lbs.

**Features:**

- Constructed of 16 gauge copper  
(Copper is a living finish and will patina over time)
- Smooth antique copper exterior and interior
- Hand polished
- No faucet holes
- Foot Leg Height: 5"
- No overflow
- Hand-crafted construction makes each tub unique
- Brass feet

**Tub Finishes:**

LC Light Copper

Due to the handmade nature of this product, variations in size and finish may occur. Such variations do not constitute manufacturer defects.

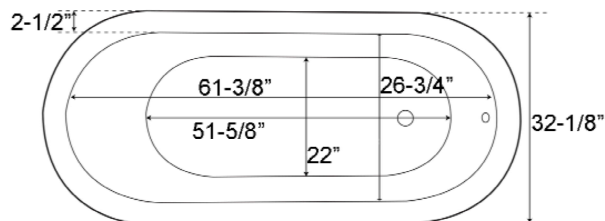
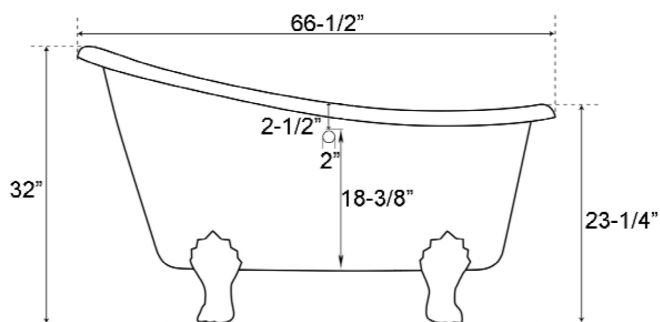

Dimensions and specifications subject to change without notice.

01/06/2026

P 847•244•1234

www.barclayproducts.com