

**68" CELANA
DOUBLE SLIPPER
COPPER TUB**

Cat. No.
COTDSN68-AC-AC



L: 67-7/8"
W: 32"
H: 31"

Rim: 2-1/2" W

Water depth: 23-1/2" to top of tub

The following is recommended for COTDS tubs without faucet holes:

- Faucet: part **#7082 or 7088**
- Double offset supplies: part **#4502 or 4502MC**
- Freestanding filler: part **#7901, 7913, 7922 or 7952**
(Supplies included with filler)



Overflow can be drilled.
With overflow drilled this tub requires drain 5599E.
Tubs that have been drilled with overflow are "special order" and are not returnable.

Gallon Capacity : 80
Shipping Weight: 221 lbs.
Empty Weight: 106 lbs.
Filled Weight: 770 lbs.

Features:

- ▶ Double slipper
- ▶ Antique Copper claw feet
- ▶ Constructed of 16 gauge copper
(Copper is a living finish and will patina over time)
- ▶ Hammered copper exterior and shiny interior
- ▶ Rim: 2-1/2"
- ▶ No faucet holes
- ▶ No overflow
- ▶ Hand-crafted construction makes each tub unique

Tub Finish:

AC Hammered Antique Copper/ Antique Copper Claw Feet

Due to the handmade nature of this product, variations in size and finish may occur. Such variations do not constitute manufacturer defects.

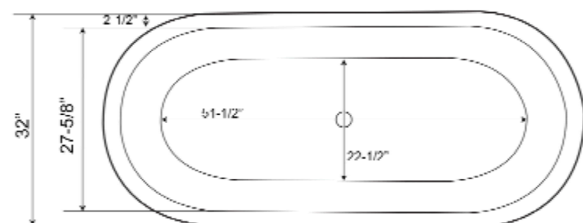
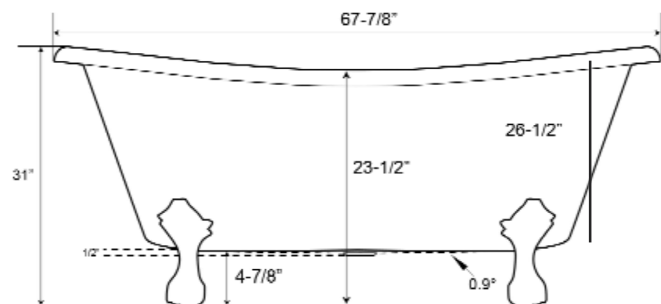

Dimensions and specifications subject to change without notice.