

CALUMET COPPER DOUBLE SLIPPER TUB

Cat. No.
COTDSN66L



L: 66"
W: 30-5/8"
H: 29-1/4"

Rim: 2-1/2" W
Water depth: 24-7/8" to top of tub

The following is recommended for COTDSN tubs without faucet holes:

- Faucet: part #7082 or 7088
- Double offset supplies: part #4502 or 4502MC
- Freestanding filler: part #7901, 7913, 7922 or 7952 (Supplies included with filler)



Overflow can be drilled. With overflow drilled this tub requires drain **5599E**. Tubs that have been drilled with overflow are "special order" and are not returnable.

Gallon Capacity: 66
Shipping Weight: 325 lbs.
Empty Weight: 108 lbs.
Filled Weight: 656 lbs.

Features:

- ▶ Made of 16 gauge copper
(Copper is a living finish and will patina over time)
- ▶ Smooth antique finish
- ▶ No overflow
- ▶ No faucet holes
- ▶ Built-in adjusters included
- ▶ Hand polished
- ▶ Includes base
- ▶ Compatible with the Air jet system, refer to Air Kit spec for details

Tub Finishes:

SAC Smooth Antique Copper

Due to the handmade nature of this product, variations in size and finish may occur. Such variations do not constitute manufacturer defects.

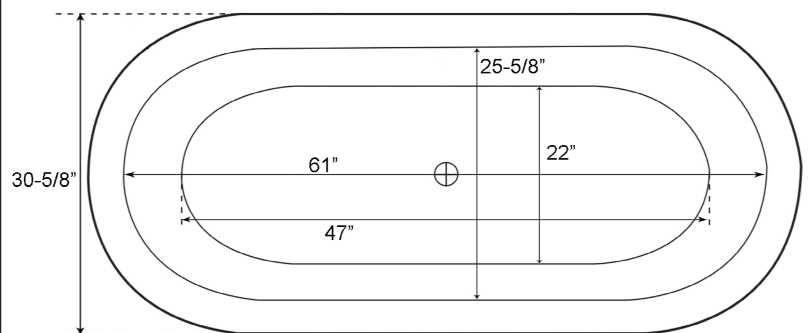
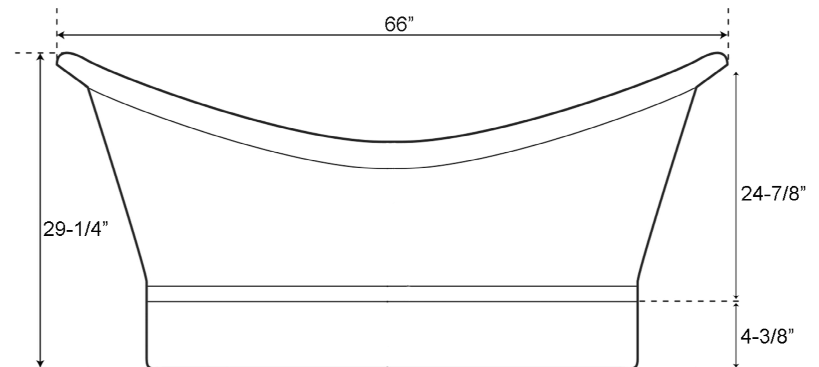

Dimensions and specifications subject to change without notice.

01/06/2026

P 847•244•1234

www.barclayproducts.com