

60" REEDLEY COPPER DOUBLE ROLL TOP TUB

Cat. No.

COTDRN61K-AC



L: 59-7/8"
W: 31-3/4"
H: 26-3/8"

Rim: 3"

Water depth: 20-3/8" to top of tub

The following is recommended for COTDRN61K tubs without faucet holes:

- Faucet: part #7082 or 7088
- Double offset supplies: part #4502 or 4502MC
- Freestanding filler:
part #7901, 7913, 7922 or 7952
(Supplies included with filler)



Overflow can be drilled.
With overflow drilled this tub
requires drain 5599E.
**Tubs that have been
drilled with overflow are
"special order" and
are not returnable.**

Gallon Capacity:	65
Shipping Weight:	325 lbs.
Empty Weight:	104 lbs.
Filled Weight:	644 lbs.

Features:

- ▶ Made of 16 gauge copper
(Copper is a living finish and will patina over time)
- ▶ Hammered antique copper inside and out
- ▶ Hand polished
- ▶ No overflow
- ▶ Double roll top with tap deck
- ▶ Includes base
- ▶ No faucet holes
- ▶ Tub is thoroughly inspected before shipment
- ▶ Compatible with the Air jet system, refer to Air Kit spec for details

Tub Finish:

AC Hammered Antique Copper

Due to the handmade nature of this product, variations in size and finish may occur. Such variations do not constitute manufacturer defects.

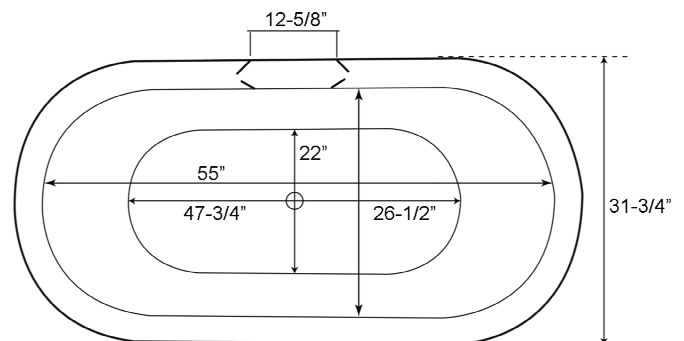
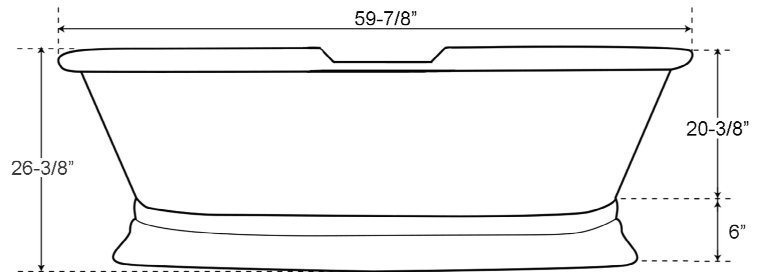

Dimensions and specifications subject to change without notice.