

71" NICOLE ACRYLIC FREESTANDING TUB

Cat. No.
ATFN71IG-XX



L: 71"
W: 31-3/4"
H: 30"

Water depth: 18-1/2" to top of tub
Water depth: 14-3/4" to overflow
Overflow hole diameter: 4-1/4"
Center drain to back of rim: 15-3/4"
Bottom of drain to floor: 4"
Bathing well to floor: 5-1/4"

**The following is recommended for
ATFN71 tubs:**

- Faucet: part #4602, 4604, 7082 or 7088
- Rigid, freestanding supplies: part #4502
- Freestanding filler: part #7902, 7922, or 7932
(Does not need bath supplies)

Gallon Capacity: 61
Shipping Weight: 162 lbs.
Empty Weight: 102 lbs.
Filled Weight: 631 lbs.



**For easier installation we
recommend use of 5598-ITD
Easy Install Rough In Kit**

Features:

- ▶ Acrylic construction for lighter weight
- ▶ Smooth inside and out
- ▶ No faucet holes
- ▶ Includes built-in adjusters
- ▶ Drain and overflow covers included (available in 6 finishes)
- ▶ Rim measurement : 1-1/2"
- ▶ Overflow slot with integrated drain
- ▶ Drain included
- ▶ Angle slope of tub: 21°
- ▶ Tub is thoroughly inspected before shipment
- ▶ Option to add foam insulation between tub walls available



Finishes:

BN Brushed Nickel
CP Polished Chrome
ORB Oil Rubbed Bronze
PB Polished Brass
PN Polished Nickel
WT White

Custom Colors Available (inside of tub is always white enamel):
Painted bathtubs are considered "special order" and are not returnable
\$160 Bisque or Black \$250 Designer Color

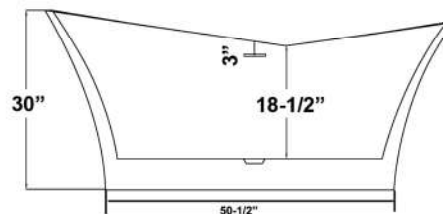
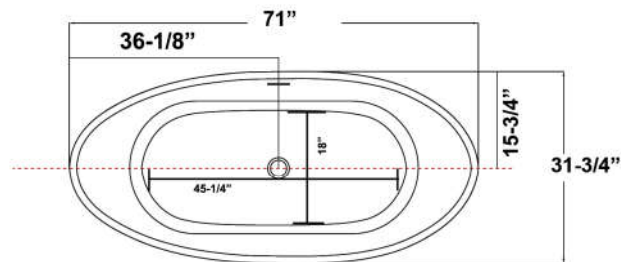

Dimensions of fixture are nominal and may vary within the range of tolerances established.