

ADDIE SMALL COPPER LAVATORY BOWL

Cat. No.
6712



Diameter: 12"
Height: 6-1/2"

Interior Dimensions:

Diameter: 10"
Basin Depth: 6-1/4"

Features:

- ▶ 16 Gauge Metal
- ▶ For undermount installation
- ▶ Round
- ▶ No overflow
- ▶ Drain opening for standard 1-1/2" drain fitting
- ▶ 1" Rim
- ▶ Flange measures 2-5/8" in diameter and 1/8" in height
- ▶ Also Available as Self-rimming (**#6713**)
- ▶ Copper is a living finish and will patina over time
- ▶ Pewter will not patina under normal circumstances

Finishes:

AC Hammered Antique Copper
PE Hammered Pewter

Due to the handmade nature of this product, variations in size and finish may occur. Such variations do not constitute manufacturer defects.

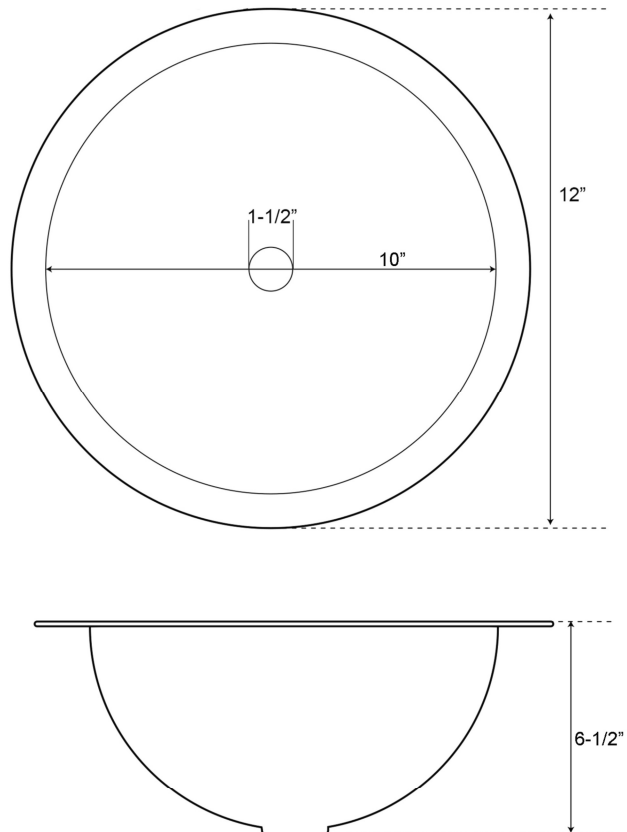

Dimensions of fixture are nominal and may vary. Dimensions and specifications subject to change without notice.

01/06/2026

P 847•244•1234

www.barclayproducts.com