

OPULENCE "His" 23 In ABOVE COUNTER BASIN

Cat. No
4-372, 373



Faucet not included

W: 22 $\frac{7}{8}$ "
D: 18 $\frac{1}{2}$ "
H: 4 $\frac{3}{4}$ "

Features:

- ▶ Fine fire clay construction
- ▶ Transitional style
- ▶ Pre-drilled overflow hole
- ▶ Rectangular basin
- ▶ Back of basin is unfinished
- ▶ Available pre-drilled for 1-hole faucet (**4-372**), 4" centerset (**4-376**), and 8" widespread (**4-373**)

Colors:

WH White

Compliance Certification
Meets or exceeds the following specifications: ASME A112.19.2 2018 and CSA B45.1-18 for ceramic plumbing fixtures.

Interior Dimensions:

Basin Interior:	18 $\frac{1}{2}$ " x 12"
Bottom of sink (outer area):	17 $\frac{5}{8}$ " x 15 $\frac{5}{8}$ "
Bottom of sink (inner area):	14" x 13 $\frac{3}{8}$ "
Basin Depth:	4 $\frac{1}{2}$ "
Water depth to overflow:	3 $\frac{1}{4}$ "
Back of basin to center of faucet:	2 $\frac{3}{8}$ "
Back of basin to center of drain:	9"
Step down on the front of the sink:	1 $\frac{1}{4}$ "
Indent on the back of the sink:	4"
Mount holes cc:	10 $\frac{5}{8}$ "
Faucet and spout holes:	1 $\frac{3}{8}$ "

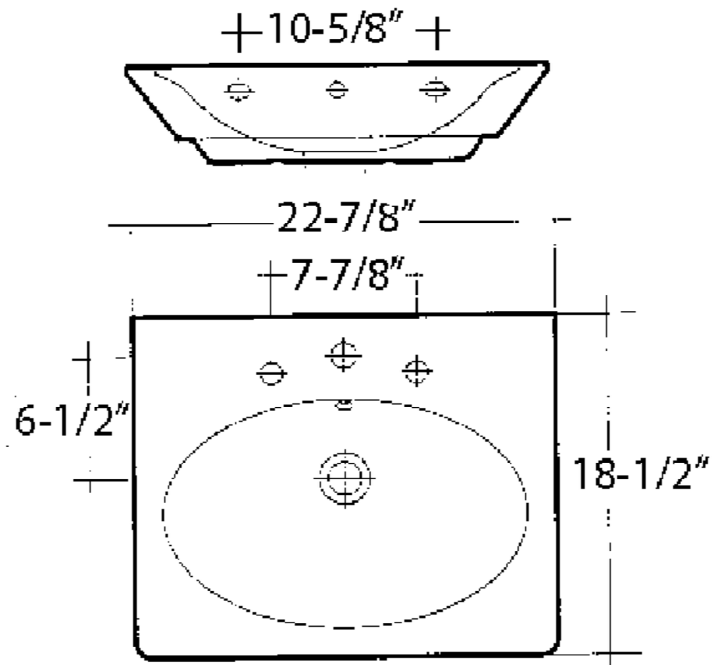

Dimensions of fixture are nominal and may vary within the range of tolerances established by ASME Standard A112.19.2. Dimensions and specifications subject to change without notice.