

## 30 SERIES DBI663PHS



## FEATURES

Premium upper and lower rack

---

Top tray with Instant Lift™

---

Heavy-duty stainless steel construction

---

Nylon-coated steel racks

---

TouchProof™ stainless steel

---

Condensation drying system

---

16 place-setting capacity

---

Quiet operation—44 dB(A)

---

8Spray™ wash system

---

Hidden controls

---

LED display

---

Delayed start

---

ADA height compliant



## PROGRAMS

- Normal Wash
- Eco Wash
- Sanitation Wash
- Time Program
- Plastic Wash
- Hygiene Wash
- Crystal Glass
- Lower Half Wash
- Upper Half Wash
- Self-Cleaning
- Rinse and Hold

**PRODUCT SPECIFICATIONS**

Model	DBI663PHS
Width	23 <sup>7</sup> / <sub>8</sub> "
Height	32 <sup>3</sup> / <sub>4</sub> "*** – 34 <sup>3</sup> / <sub>4</sub> "
Depth	22"
Door Clearance	24 <sup>5</sup> / <sub>8</sub> "
Weight	112 lb
Electrical Supply	115 VAC, 60 Hz
Service	15 amp dedicated circuit
Receptacle	3-prong grounding-type
Power Cord	4'
Water Connection	6' PEX tubing with 3/8" NPT female connection
Drain Connection	5' corrugated tubing
Pressure	4.2–140 psi

Electrical supply, plumbing supply, and drain should be located in an adjacent cabinet. If not, they must be located within the shaded area shown in the illustrations below.

**ELECTRICAL | PLUMBING**



**DIMENSIONS**

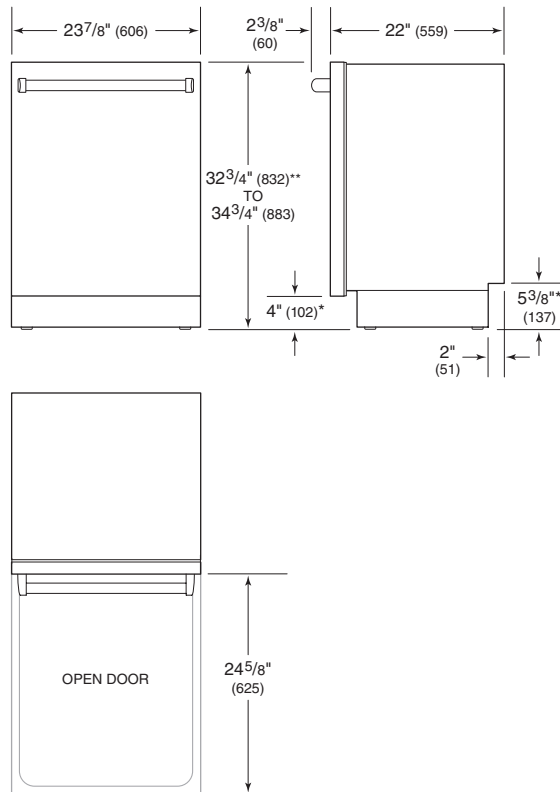

\*Dimension will vary with product height.  
\*\*Can be reduced to 32<sup>1</sup>/<sub>4</sub>" (819).

**INSTALLATION**

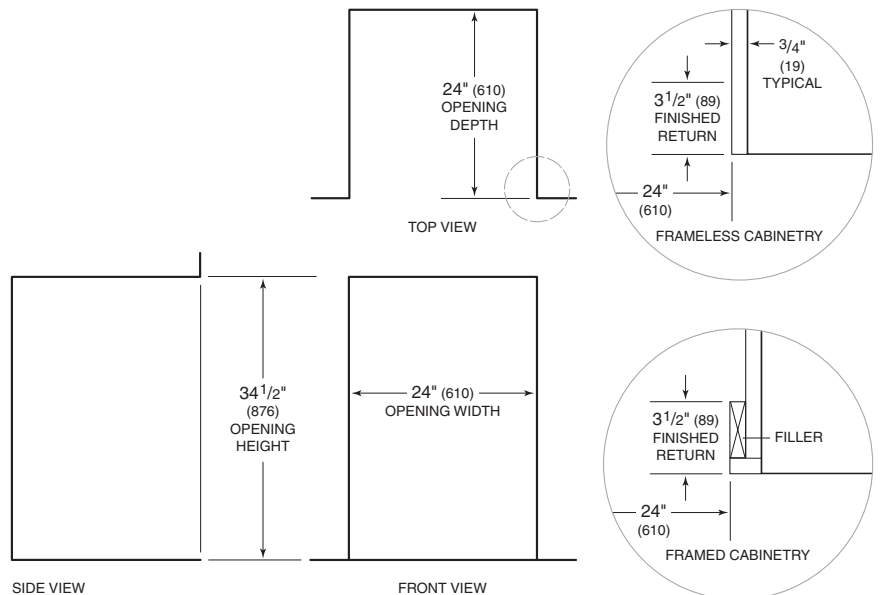

NOTE: 3<sup>1</sup>/<sub>2</sub>" (89) finished returns will be visible and should be finished to match cabinetry.