

SILICONE FLAPPER SEAL

PART NUMBERS:
7381424-100.0070A

TO REPLACE SILICONE SEAL:

- Turn off water supply; flush toilet (remove all water from the tank)
- Remove hair pin **FIGURE 1**
- Remove clevis pin; this frees the teeter bar from the trip lever arm **FIGURE 1**
- Place fingers underneath hinge and pull up to release all 4 hinges **FIGURE 2**
- Remove original flapper assembly from tank
- Firmly grab silicone gasket and massage the tabs from one side of the flapper while pulling away from the plastic frame **FIGURE 3**

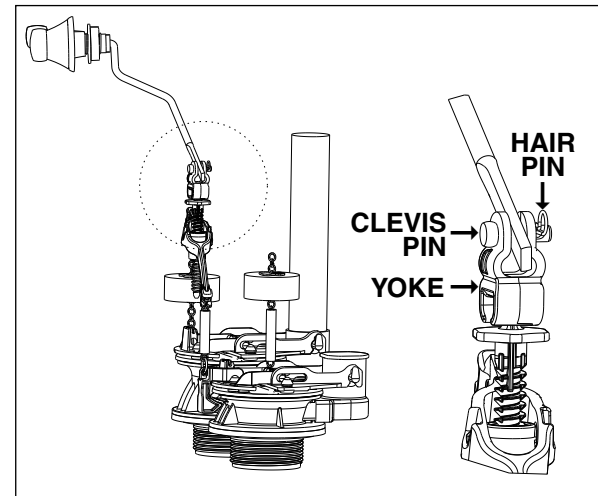

FIGURE 1

TO RE-ASSEMBLE:

- Push the tabs on the silicone flapper through appropriate openings of flush valve frame **FIGURE 3**
- Place the black flapper to the black flush valve body with the overflow tube and the red flapper to the flush valve body with the red cap and push all 4 hinges in place (red to red/black to black)
- Insert the trip lever arm in to the yoke **FIGURE 1**
- Push the clevis pin through the arm **FIGURE 1**
- Insert the hair pin **FIGURE 1**

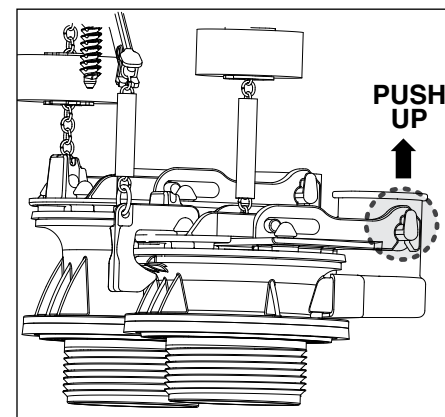

FIGURE 2

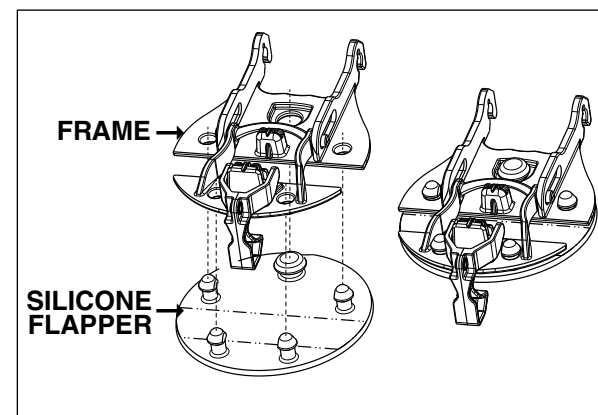

FIGURE 3



www.americanstandard-us.com/vormaxparts

SILICONE FLAPPER SEAL

PART NUMBERS:
7381424-100.0070A

COMPLETE BY ADJUSTING THE SETTINGS:

- Depress trip lever handle all the way **(A)**
- Adjust screw on the teeter bar **(B)** so rear frame **(C)** touches the frame stop **(D)**
- Return trip lever handle **(A)** to rest position.
- Make sure hook **(E)** is fully engaged under tab on valve body **(F)**, if not, slightly adjust screw to make sure hook is engaged.
- Turn water supply on; adjust water level to specified dimension on back of tank and flush 5 times to prime

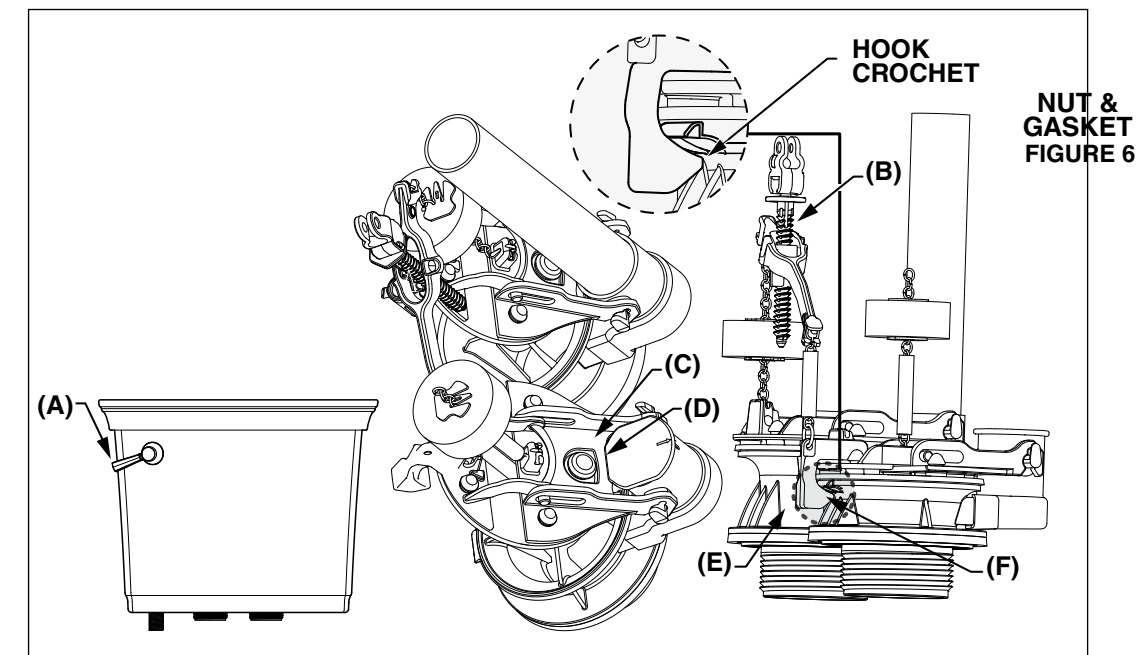

www.americanstandard-us.com/vormaxparts