

One-Piece Shower/Tub Shower Installation Instructions

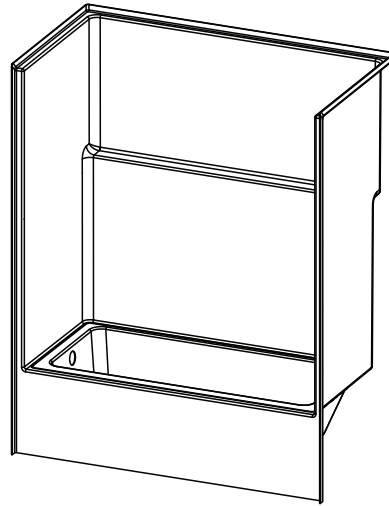
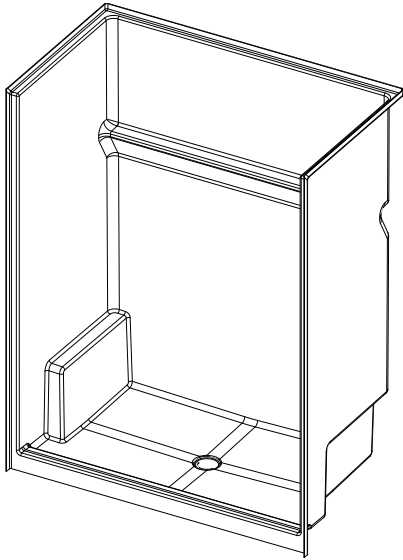

Materials and tools you may need for proper installation:

Materials:

- Screws
 - Flat head wood screws for wood studs
 - Self-tapping sheet metal screws for metal studs
- 2 large soft cloths
- 3 gallons of water (for testing slope to the drain)
- Drain kit (Provided by others)

Tools:

- Hammer
- Drill
- 1/8 in. Drill bit
- Screwdriver
- 4 ft. level
- 2 ft. level
- Torpedo level
- Black Marker (to mark the threshold)

NOTICE: Please inspect the unit thoroughly before installation to make sure it has not been damaged during transportation. Under no circumstances should a damaged unit be installed. Neither the manufacturer nor the distributor will be responsible for the removal or reinstallation costs should a replacement be necessary due to installation of a damaged unit

STORAGE AND HANDLING

- Do not store unit(s) outdoors. Keep out of sunlight and exposure to weather.
- Most handling damage is the result of impact blows to the back side of the shower unit.
- Stress cracks can develop when shipping boards are removed before the unit is positioned for final installation in bathroom.
- Placing objects inside the tub or shower may cause scratches, abrasions, or nicks to the finished surface.
- Storing units outside right-side up may cause sunlight to discolor the AcrylX finish. The unit may become unstable and is easily knocked over by wind or by being bumped.
- The back side of the shower unit is not waterproof. Unit must be stored so that water will drain off of the unit and not accumulate in any one spot. Water can permeate the back laminates and soak the glass enclosed wood supports causing bulges in the finished surface.
- Never drag these units on any surface. Always transport the unit by hand using two people or a two-wheel dolly.
- Do not clean the shower finished surface with metal tools of any kind, including razors
- Wall board with water resistant finished material must be installed to complete the shower enclosure.
- Do not remove the medallion identification number. Doing so may affect the warranty. This number may be found above the drain, or on the left or right hand corner of the unit.

One-Piece Shower/Tub Shower Installation Instructions

Pre-Installation Planning

1. Unit must be placed within bathroom area before completion of door framing or, if preferred, studs may be omitted or knocked-out to permit unit placement.
2. Review job print and the manufacturer's rough-in dimensions; verify all key dimensions against actual job conditions. Make sure framed-in alcove is of proper size, square and plumb; check floor for levelness.
3. The feet and/or legs attached underneath the bottom of the bath fixture are an integral part of the support system and should not be removed. For an acceptable installation of the unit, feet and/or legs must contact the sub floor.
4. If fire-rated alcove is required, approved finish material must be in place prior to unit installation to meet fire safety requirements of local building code and/or FHA/HUD Minimum Property Standards. NOTE: Finished alcove must have interior dimensions shown on rough-in diagram to permit installation of unit.
5. Showers: Provide 6" (150mm) floor opening for 2" (50mm) IPS and drain connection.
Tub-Showers: Provide 6 x 12 (130 x 300) floor opening for 1 1/2" (40mm) drain, waste and overflow (DWO) kit. NOTE: Be sure floor opening location matches bath fixture drain location.
6. To avoid obstruction, make sure that supply lines and valve plumbing are not strapped to studs and do not project into alcove. Also, drain pipe must not project above floor level prior to installation.
7. Make sure all plumbing is complete and to code.
8. To prevent scuffing while installing unit, cover the entire bottom of the unit with a piece of cardboard or other protective material.
9. Fasten drain fitting to unit before installing [see manufacturer's instructions].

NOTE: For installation on gypsum concrete refer to gypsum concrete manufacturer for information about adhesion.

Standard Installation Instructions (for a foundation material bed install see page 5)

Note: If fire-rated alcove is required, approved finish material must be in place prior to unit installation to meet fire safety requirements of local building codes and/or FHA/HUD Minimum Property Standards.

NOTE: For shower instructions follow Figures "A", for Tub Showers follow Figures "B".

1. Check dimensions. Make sure framed-in alcove is of proper size, square and plumb.

See Figures 1A and 1B.

1A

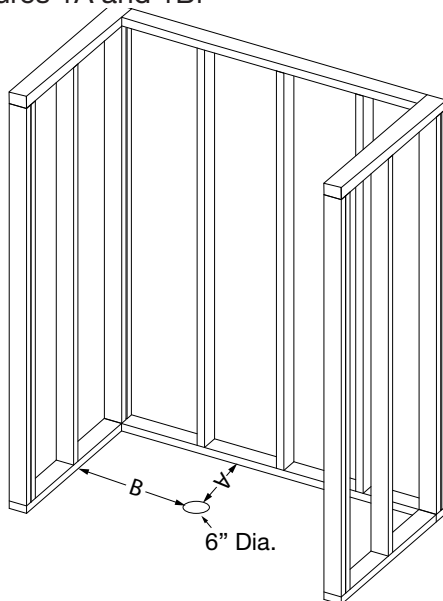

1B

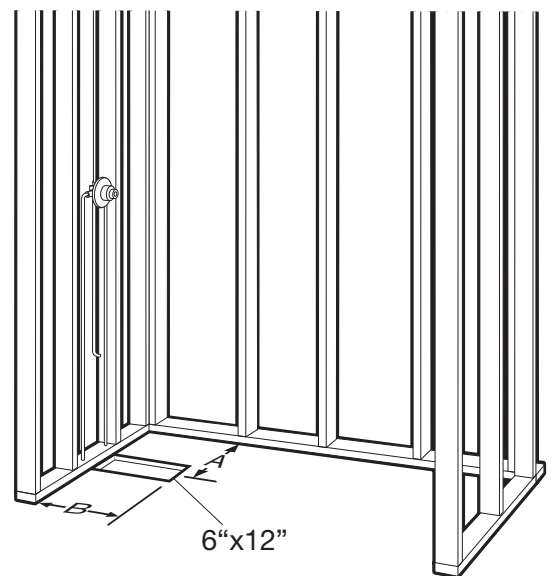

2. If mounting fittings — from stable reference points (back wall studs, floor) measure the locations of spout and valves. Note measurements below. See Figures 2A and 2B.

One-Piece Shower/Tub Shower Installation Instructions

2A

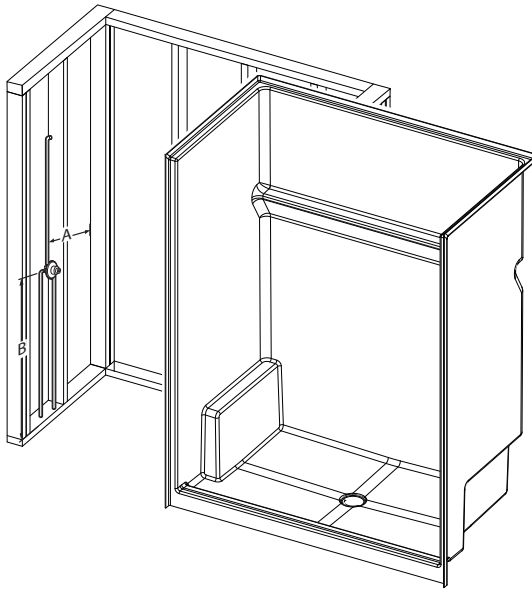

2B

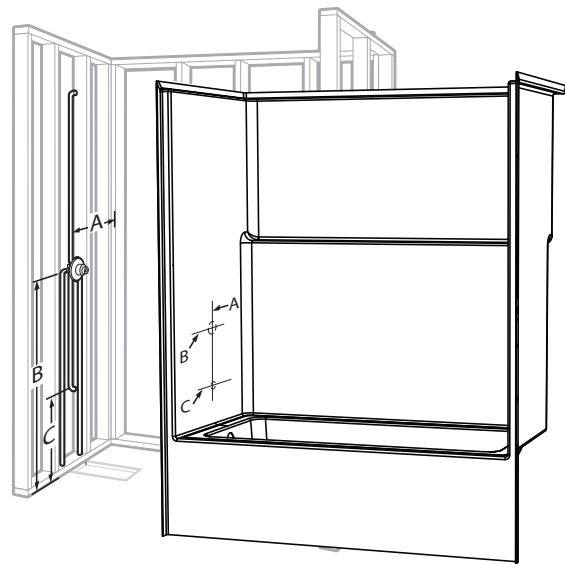

3. Mark fitting locations. (Refer to measurements from step 2.) Using a hole saw (fine tooth or abrasive grit cutting edge), make necessary openings for filler and valves, drilling from inside (smooth side) out. See Figures 3A and 3B.

3A

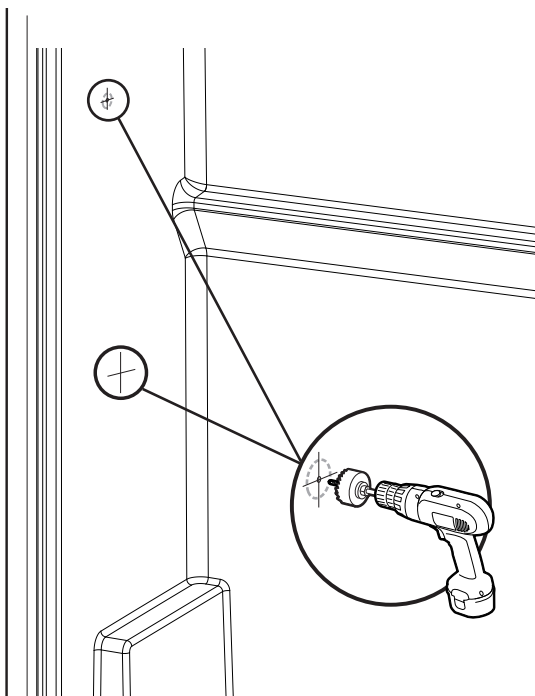

3B

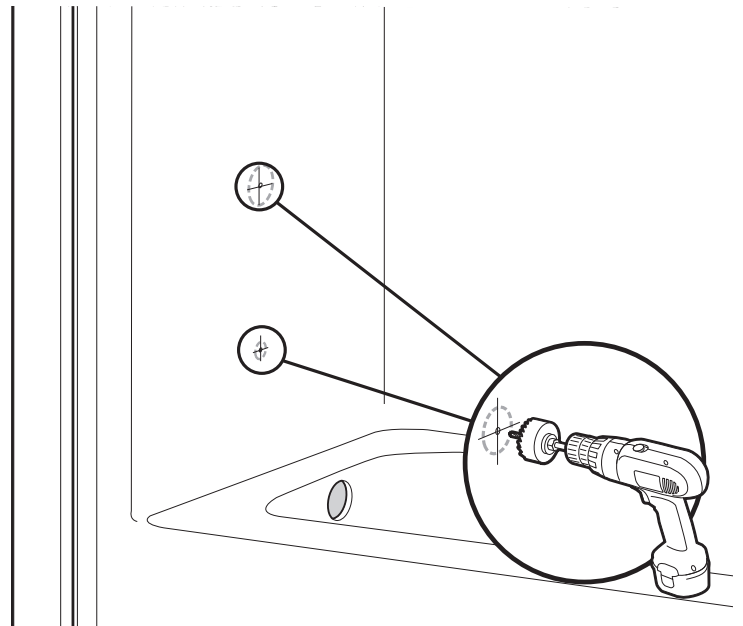

4. Place the unit into framing with drain fitting over and onto waste pipe with skirt firmly on the floor. Maintain proper floor slope towards drain. See Figures 4A and 4B. For showers only, assure waste pipe protrudes well into drain fitting. See figure 4C.

One-Piece Shower/Tub Shower Installation Instructions

4A

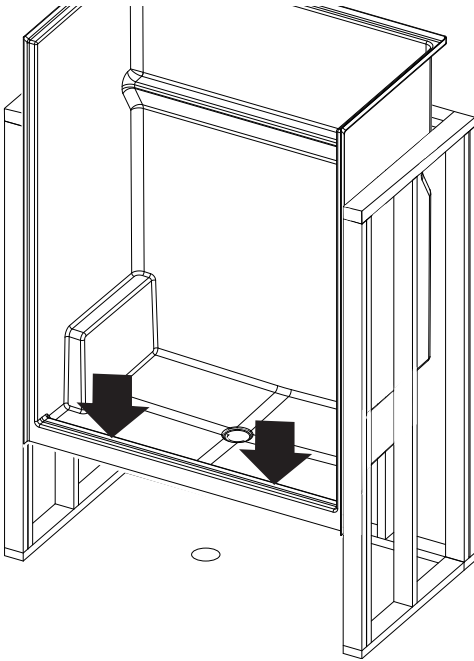

4B

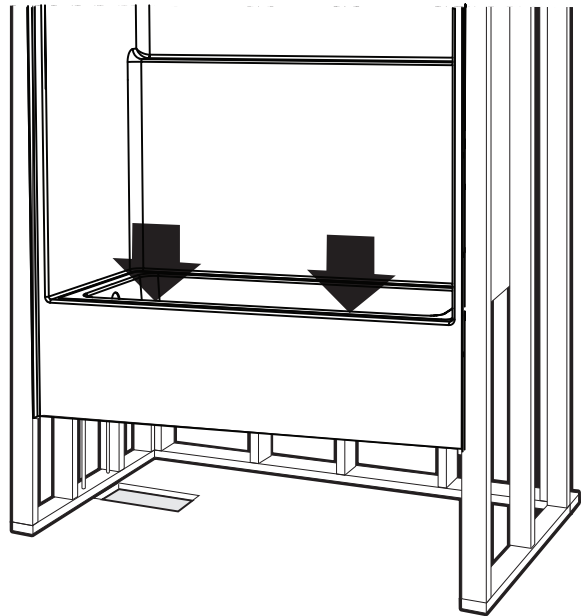

4C

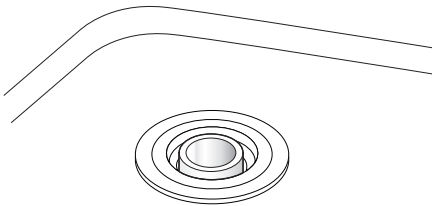

5. Check for level. See Figures 5A and 5B.

5A

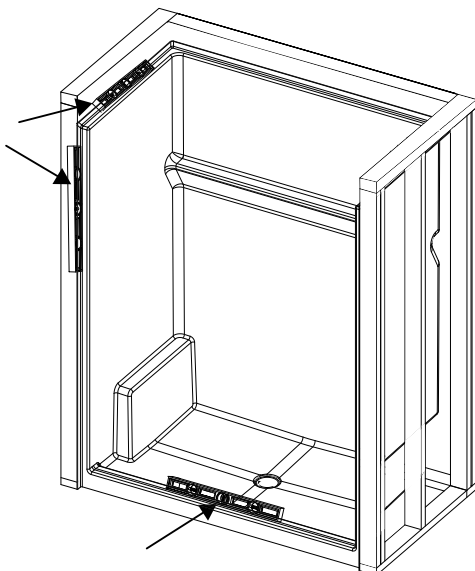

5B

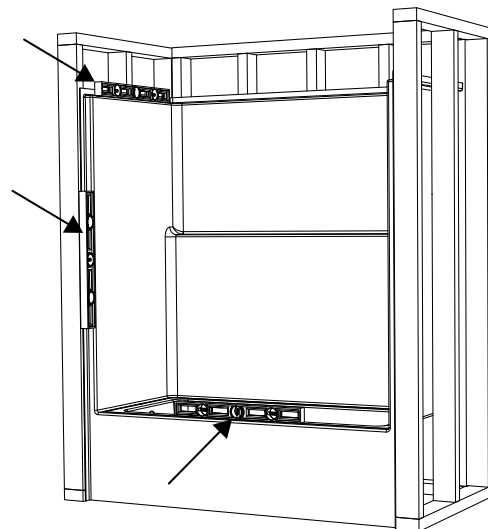

One-Piece Shower/Tub Shower Installation Instructions

6. Pre-drill pilot holes. Fasten panel to framing at every stud and eight inches vertically through nailing flange. See Figures 6A and 6B.

6A

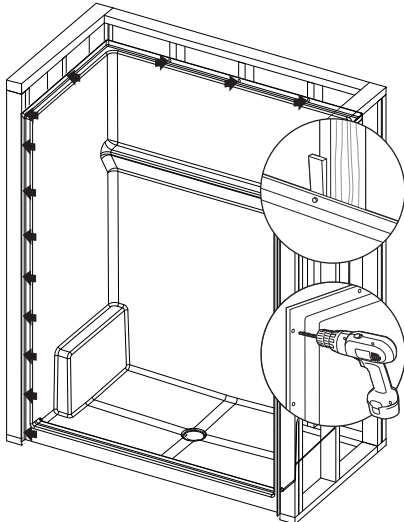

6B

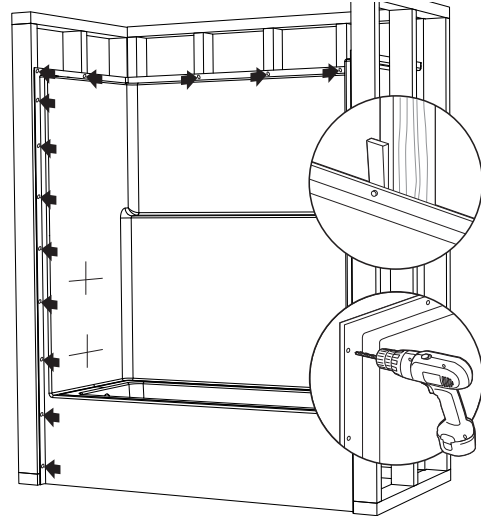

7. Ensure the drain is properly installed per manufacturer instructions. Test unit for proper drainage by pouring 3-5 gallons of water into the shower and monitoring. If the unit does not drain properly, the unit must be pulled back up to determine where the problem lies.

WARNING: Continuation of installation without water testing will void warranty service if water does not drain completely following installation.

8. When other than cementitious backer board plaster is to be used, furring strips as thick as nailing flanges are recommended for installation on studs above the installed unit to assure walls will be flush.

Installation Instructions of Gypsum Concrete or Other Foundation Material

1. Install drain on the unit. Follow manufacturer installation instructions for the drain.
2. Refer to architectural drawings for the height of gypsum concrete or foundation material to be added after the unit has been installed. Use this height to determine the installation height of the unit. Mark this height on the studs with a marker. Also draw a line across the front of the unit.

NOTE: The bottom edge of the front apron (threshold) and any feet or supports on the bottom of the unit must contact the gypsum concrete or foundation material when it has fully cured.

3. Move the unit into place. Position the unit at the open end of the framed pocket. Align the lower edge of the apron with the mark made in Step 2 and tilt the unit back into place. Carefully guide the drainpipe through the shower drain assembly for showers). Lower the unit until it aligns with the marks that were made in Step 2.
4. Level the unit across the finished flat sides of the unit and across the back edge. Ensure that the unit is solid, plumb, and level in both directions.
5. Mount the unit to the studs using appropriate screws.

IMPORTANT: Do not step on the shower floor after it has been installed until foundation material has fully cured.

6. Finish installation of the drainpipe into the shower drain assembly. If necessary, trim the pipe length. Insert gasket around the drainpipe in the drain fitting and make final connections.

NOTE: Manufacturer is not responsible for leaking drain connections.

7. Test unit for proper drainage by pouring 3-5 gallons of water into the unit and monitoring. If the unit does not drain properly, the unit must be pulled back up to determine where the problem lies.

Following the appropriate installation procedures is imperative for this product. Not following these procedures could result in product failure, which will not be covered under the manufacturer's warranty.

Questions?

Please call 1.800.443.7269 for US Customers