

CUSTOMER: \_\_\_\_\_

JOB NAME: \_\_\_\_\_

PO #: \_\_\_\_\_ QUOTE # \_\_\_\_\_

DATE: \_\_\_\_\_ QUANTITY: L \_\_\_\_\_ R \_\_\_\_\_

SHIP TO: \_\_\_\_\_

One Signature Required

_____	PLUMBING CONTRACTOR APPROVAL	____/____/____
_____	GENERAL CONTRACTOR APPROVAL	____/____/____
_____	ENGINEER APPROVAL	____/____/____
_____	ARCHITECT APPROVAL	____/____/____

To complete your order, this document must be signed and emailed to the Centralized Customer Service Center.  
**quotes@americanbathgroup.com • 800.443.7269**

**STANDARD FEATURES**

- Pre-leveled base
- AcrylX™ applied acrylic surface
- 1 1/8" skirt
- Compliant when properly installed
- Center front drain outlet
- Integral front trench drain
- 5-year limited warranty
- 12" x 24" subway tile
- Slip resistant, textured bottom [ASTM F-462]

Int. Dim.	48 W x 36 D x 76 3/4 H
Ext. Dim.	54 W x 38 1/8 D x 78 3/4 H
Skirt Ht.	1 1/8 skirt
Packaged Wt.	170 lbs.
Material	AcrylX™ applied acrylic
Warranty	30-year warranty*

\* See terms and conditions for details

inches

**CONFIGURATION (handed by fixture wall)**

- Shell reinforced for future accessory installation  
Fixture wall  LH  RH  Back wall  
 Optional vertical bar reinforcement (entry wall)  
 LH  RH  Both
- Fully configured  
Fixture Wall (must choose one)  LH  RH  Back Wall  
Includes two stainless steel 28" x 1 1/2" grab bars located on the side wall and one stainless steel 36" x 1 1/2" grab bar located on the back wall  
 Factory-installed plumbing options  
 Hand-held shower assembly, 30" slide bar and 60" hose  
 Pressure balancing mixing valve

**OPTIONAL ACCESSORIES (available for all models)**

- Stainless steel vertical bar 24" x 1 1/2" (entry wall)  
 LH  RH  Both
- Large soap dish (12 1/2 W x 3 1/2 D x 1 1/2 H), shipped loose
- Small soap dish (7 W x 3 1/2 D x 1 1/2 H), shipped loose
- Curtain rod, shipped loose
- Shower curtain, shipped loose
- Brass drain
- Colors:  
Standard  White  
Upgraded  Biscuit  Bone  
 Other (contact customer service for custom color options)
- Additional accessories:

**CUSTOM OPTIONS**

- Grab bars:  
 Horizontal U-shaped bars: 28" (side walls), 18" (back wall)  
 Vertical bar 24" (entry wall)  LH  RH  Both
- Grab Bar finish:  
 Stainless steel (1 1/2" dia.)  
 Powder-coated white (1 1/4" dia.)
- Factory-installed plumbing options  
 Hand-held shower assembly, 30" slide bar and 60" hose  
 Pressure balancing mixing valve  
Fixture wall  LH  RH  Back wall
- Grate:  
 Stainless steel  
 White  
 Tamper-proof

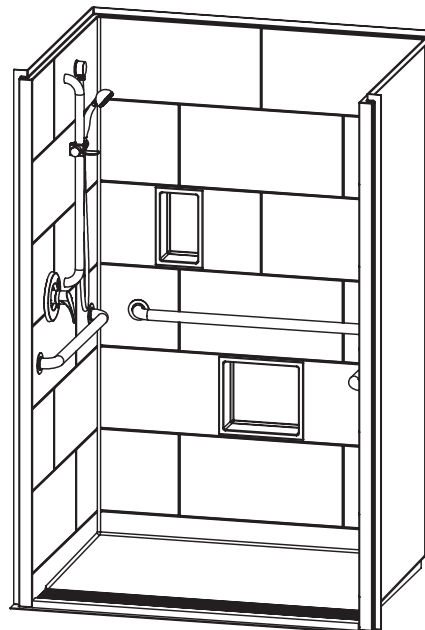

Left wall left fixture placement configuration shown with optional soap dish



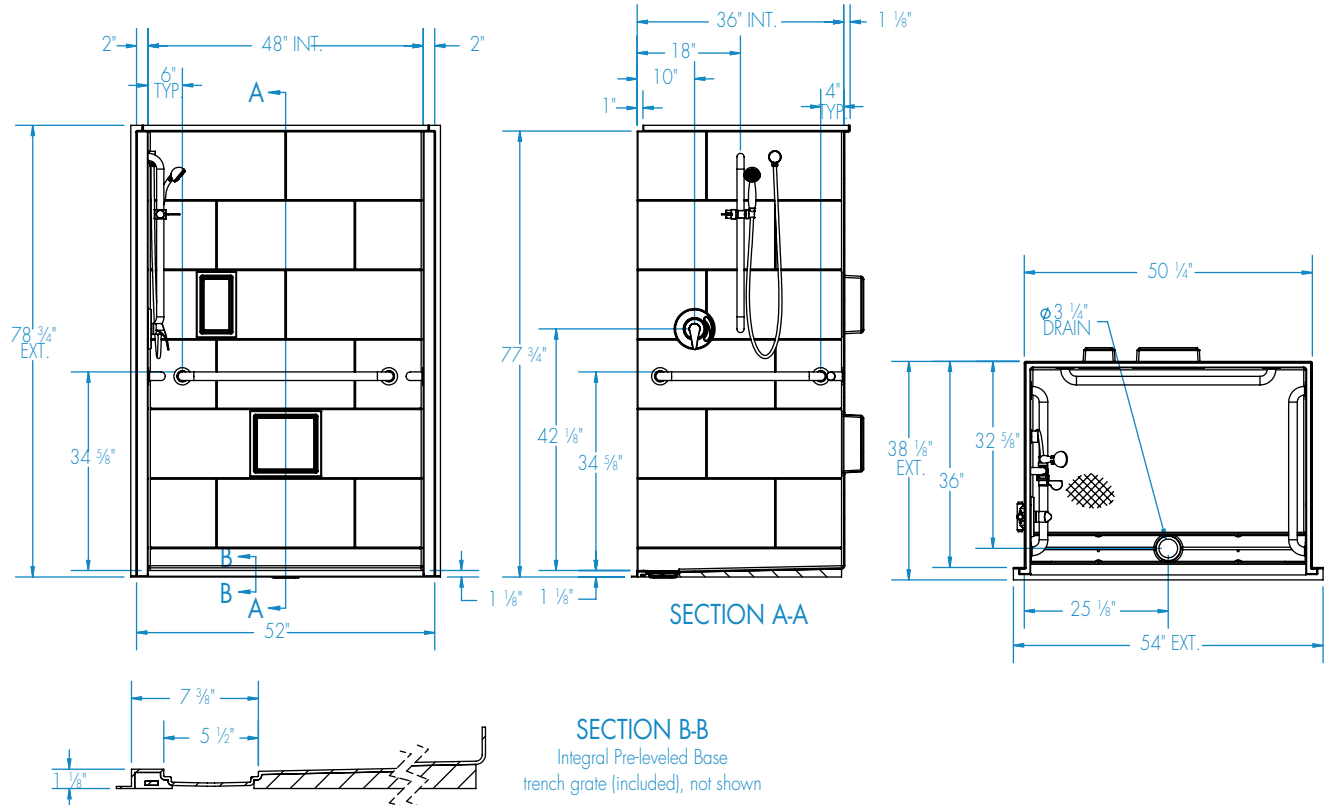

**FEATURES** lbs Dimensional Tolerance  $\pm \frac{3}{16}$ ". Dimensions needed for site preparation should be measured from the unit. Manufacturer assumes no responsibility for preparatory work.

Type and Model #	Material	Wall Finish	Pieces	Drain	Dam/Skirt Height	Net Wt.	Pkg. Wt.
Shower AQT5038TR 1.125	AcrylX™ applied acrylic	Smooth tile	1	Center Front	1 1/8" skirt	160	170

**DIMENSIONS**

Specifications	inches (mm)
Width: Ext. / Int.	54 / 48
Depth: Ext. / Int.	38 1/8 / 36
Height: Ext. / Int.	78 3/4 / 76 3/4
Enclosure Opening:	48
Skirt Height:	1 1/8
Drain Rough-In (from Back Wall)	32 5/8
Drain Rough-In (from Side Wall)	25 1/8

**FRAMING DIMENSIONS** inches (mm)

Type	D Depth	W Width	H Height	A	B	C
Alcove	36	50 1/4	-	Box Out	25 1/8	32 5/8

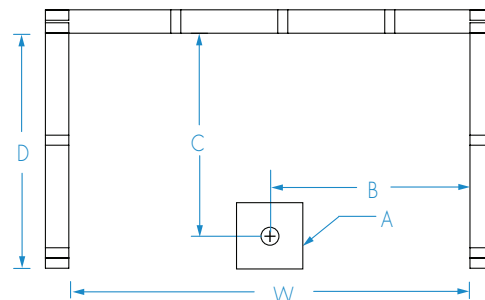

EMAIL TO THE CENTRALIZED CUSTOMER SERVICE CENTER: [quotes@americanbathgroup.com](mailto:quotes@americanbathgroup.com)