

CUSTOMER: _____

One Signature Required

JOB NAME: _____

PO #: _____ QUOTE # _____

DATE: _____ QUANTITY: L _____ R _____

SHIP TO: _____

PLUMBING CONTRACTOR APPROVAL

____/____/____
DATE

GENERAL CONTRACTOR APPROVAL

____/____/____
DATE

ENGINEER APPROVAL

____/____/____
DATE

ARCHITECT APPROVAL

____/____/____
DATE

To complete your order, this document must be signed and emailed to the Centralized Customer Service Center.

quotes@americanbathgroup.com • 800.443.7269

STANDARD FEATURES

- Pre-leveled base
- AcrylX™ applied acrylic surface
- 1 1/8" skirt
- Compliant when properly installed
- Center front drain outlet
- Integral front trench drain
- 5-year limited warranty
- 12" x 24" subway tile
- Slip resistant, textured bottom [ASTM F-462]

CONFIGURATION (handed by fixture wall)

- ☐ Shell reinforced for future accessory installation
 - Fixture wall ☐ LH ☐ RH ☐ Back wall
 - ☐ Optional vertical bar reinforcement (entry wall)
 - ☐ LH ☐ RH ☐ Both
- ☐ Fully configured — ADA
 - Fixture Wall (must choose one) ☐ LH ☐ RH ☐ Back Wall
 - Includes two stainless steel 24" x 1 1/2" grab bars located on the side wall and one stainless steel 48" x 1 1/2" grab bar located on the back wall, per ADA guidelines. (std config)
 - ☐ Factory-installed plumbing options per ADA requirements
 - ☐ Hand-held shower assembly, 30" slide bar and 60" hose
 - ☐ Pressure balancing mixing valve

CUSTOM OPTIONS (not available if ADA configuration is selected)

- Grab bars:
 - ☐ Horizontal U-shaped bars: 24" (side walls), 48" (back wall)
 - ☐ Vertical bar 24" (entry wall) ☐ LH ☐ RH ☐ Both
- Grab Bar finish:
 - ☐ Stainless steel (1 1/2" dia.)
 - ☐ Powder-coated white (1 1/4" dia.)
- ☐ Factory-installed plumbing options per ADA requirements
 - ☐ Hand-held shower assembly, 30" slide bar and 60" hose
 - ☐ Pressure balancing mixing valve
- Fixture wall ☐ LH ☐ RH ☐ Back wall
- Grate:
 - ☐ Stainless steel
 - ☐ White
 - ☐ Tamper-proof

Int. Dim.	60 W x 34 D x 76 3/4 H
Ext. Dim.	66 W x 36 1/8 D x 78 3/4 H
Skirt Ht.	1 1/8 skirt
Packaged Wt.	210 lbs.
Material	AcrylX™ applied acrylic
Warranty	30-year warranty*

* See terms and conditions for details

inches

OPTIONAL ACCESSORIES (available for all models)

- ☐ Stainless steel vertical bar 24" x 1 1/2" (entry wall)
 - ☐ LH ☐ RH ☐ Both
- ☐ Large soap dish (12 1/2 W x 3 1/2 D x 1 1/2 H), shipped loose
- ☐ Small soap dish (7 W x 3 1/2 D x 1 1/2 H), shipped loose
- ☐ Curtain rod, shipped loose
- ☐ Shower curtain, shipped loose
- ☐ Brass drain
- Colors:
 - Standard ☐ White
 - Upgraded ☐ Biscuit ☐ Bone
 - ☐ Other (contact customer service for custom color options)
- ☐ Additional accessories:

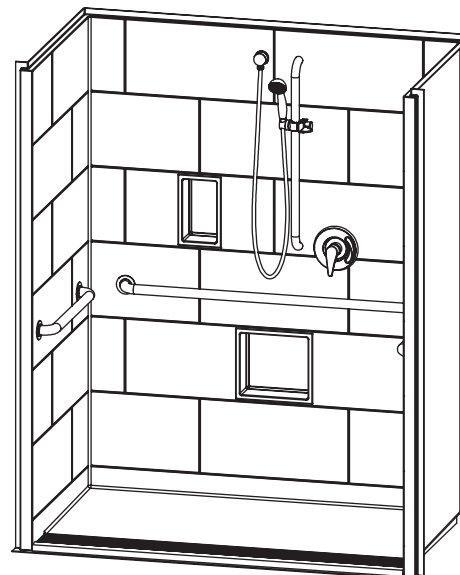

Back wall right fixture placement configuration
shown with optional soap dish



ADA/ANSI compliant when fully equipped
and installed according to guidelines.

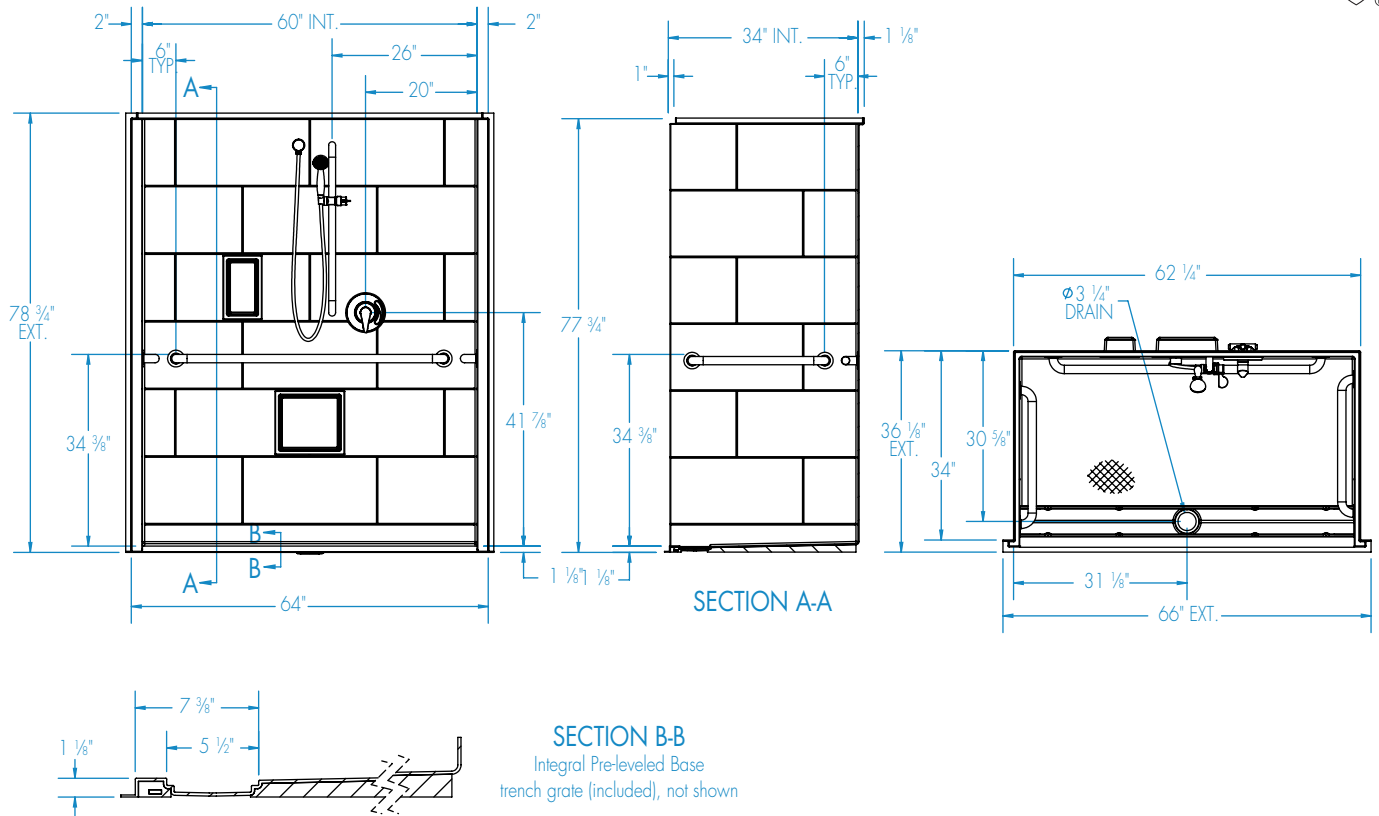

FEATURES lbs Dimensional Tolerance $\pm \frac{3}{8}$ ". Dimensions needed for site preparation should be measured from the unit. Manufacturer assumes no responsibility for preparatory work.

Type and Model #	Material	Wall Finish	Pieces	Drain	Dam/Skirt Height	Net Wt.	Pkg. Wt.
Shower AQT6236TR 1.125	AcrylXTM applied acrylic	Smooth tile	1	Center Front	1 1/8" skirt	200	210

DIMENSIONS

Specifications	inches (mm)
Width: Ext. / Int.	66 / 60
Depth: Ext. / Int.	36 1/8 / 34
Height: Ext. / Int.	78 3/4 / 76 3/4
Enclosure Opening:	60
Skirt Height:	1 1/8
Drain Rough-In (from Back Wall)	30 5/8
Drain Rough-In (from Side Wall)	31 1/8

FRAMING DIMENSIONS inches (mm)

Type	D Depth	W Width	H Height	A	B	C
Alcove	34	62 1/4	—	Box Out	31 1/8	30 5/8

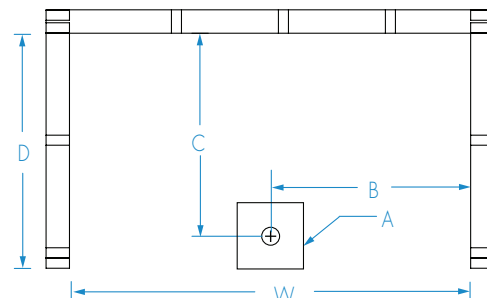

EMAIL TO THE CENTRALIZED CUSTOMER SERVICE CENTER: quotes@americanbathgroup.com