

TECHNICAL SPECIFICATIONS

KDTS 3060

MODEL NUMBER 142006

DIMENSIONS: 59 7/8" x 30 1/8" x 77 1/2" Gelcoat

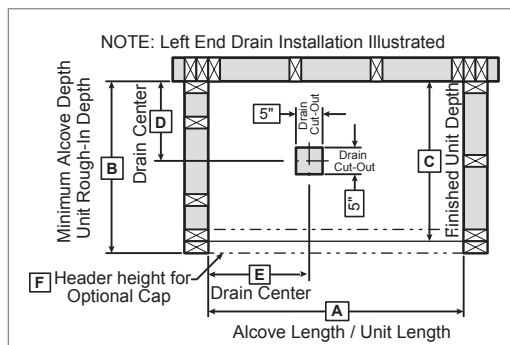
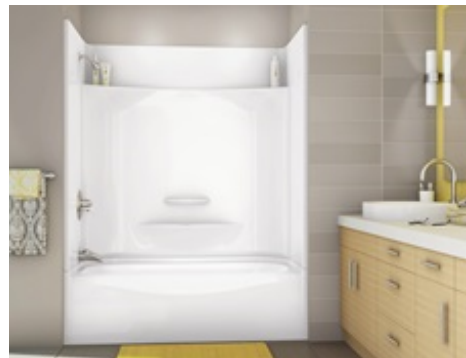

Model	A	B	C	D	E
142006	60"	31"	30"	14 5/8"	8 1/8"

STANDARD FEATURES

- Four-piece gelcoated fiberglass tub-shower with PIN system for easy front installation
- Large top corner shelves, wide soap dish and standard acrylic handle (opt. metallic finishes)
- Bottom bathing well: 44 1/8 inch L x 20 inch W
- Optional unique features:
Reinforced walls and grab bars
- Product also available in Above-the-Floor Rough (AFR)
- Right or left-hand drain
- Textured floor
- 14 3/8 inch deep sump

UNIQUE FEATURES

- PIN system

OPTIONS

- Shower base only KDTS 3060 with pin system
- Side walls (right and left) for KDTS 2954, KDTS 3060 and KDS 3060
- Back wall for KDTS 3060, KDTS 3260, KDS 3060 and KDS 3460
- Wall reinforcement (one wall)
- In-line heater (factory-installed)
- Pump position opposite standard position

SYSTEMS

Homestead **DOOR**
CERTIFICATIONS
SELECTION
AKER products adhere to one or more of
Certification Agencies complete
shower door offering VISIT
www.akerbymaax.com

Project :

Contractor :

AKER Representative : Tel :

Date :

TECHNICAL SPECIFICATIONS

KDTS 3060

MODEL NUMBER 142006

TECHNICAL DRAWINGS

STANDARD

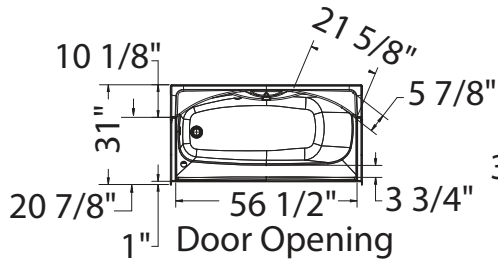

NO SYSTEM

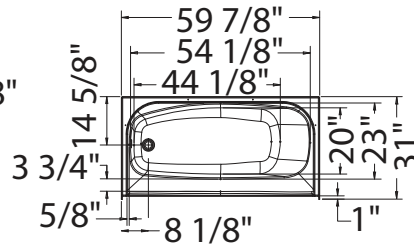

REINFORCEMENT BACKING

OPTION 20212-L Shown
OPTION 20212-R Symetrical

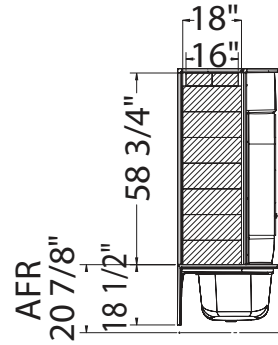

NOT ABOVE-THE-FLOOR

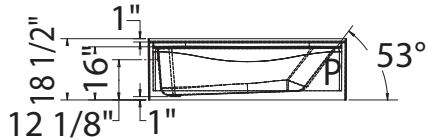

ABOVE-THE-FLOOR

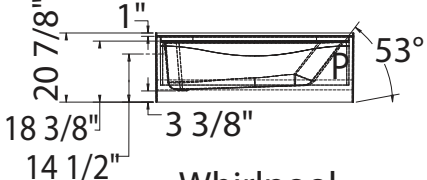

Whirlpool



OPTION 20212-B

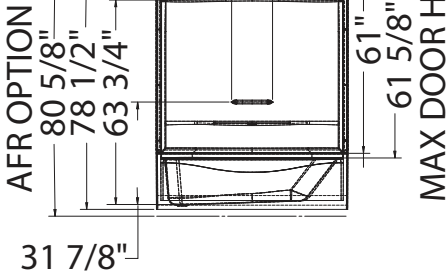
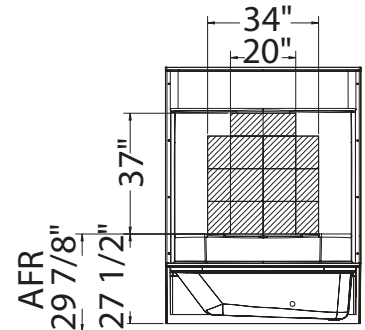

GRAB BARS

OPTION 20203

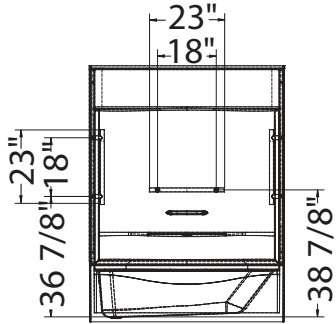

OPTION 20204

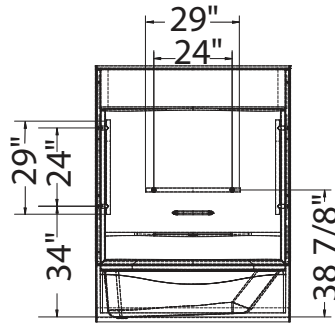

OPTION 20203-20204

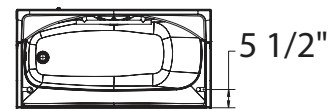

(▲): Indicates Whirlpool jets positioning
(△): Indicates suction positioning

All dimensions are approximate. Structure measurements must be verified against the unit to ensure proper fit.