

access

LIGHTING

INSTALLATION INSTRUCTIONS

IMPORTANT SAFETY INSTRUCTIONS

MESURES DE SECURITE A RESPECTURE

Before assembling your ACCESS LIGHTING fixture, please make sure that you carefully read through this instruction sheet. Save this instruction sheet and refer to it when additions to or changes in the fixture configuration are made.

Lisez attentivement ce manuel d'instructions. Enregistrer cette feuille d'instructions et de s'y référer lorsque les ajouts ou changements dans la configuration de montage sont faites.

CONSULT A QUALIFIED ELECTRICIAN TO ENSURE CORRECT BRANCH CIRCUIT CONDUCTOR.

CONSULTER UN ELECTRICIEN QUALIFIE POUR VOUS ASSURER QUE LES CONDUCTEURS DE LA DERIVATION SONT ADEQUATS

THIS PRODUCT MUST BE INSTALLED IN ACCORDANCE WITH THE APPLICABLE INSTALLATION CODE BY A PERSON FAMILIAR WITH THE CONSTRUCTION AND OPERATION OF THE PRODUCT AND THE HAZARDS INVOLVED.

CE PRODUIT DOIT ETRE INSTALLE SELON LE CODE D'INSTALLATION PERTINENT, PAR UNE PERSONNE QUI CONNAIT BIEN LE PRODUIT ET SON FONCTIONNEMENT AINSI QUE LES RISQUES INHERENTS

NOTE: The important safeguards and instructions that appear in this manual are not meant to cover all possible conditions and situations that may occur. It must be understood that common sense, caution and care, are factors that can't be built into any product. These factors must be supplied by the person(s) caring for and operating the fixture.

Read all instructions

Do not install this fixture in hazardous locations.

N'installez pas cet appareil dans des emplacements dangereux.

Do not install any fixture assembly closer than 6 inches from any curtain or similar combustible material.

Laissez une distance d'au moins 6 pouces entre ce luminaire et la toute surface combustible.

"WARNING Risk of Fire and Electric Shock."

"CAUTION: Risque d' Incendie et de Choc Electriques."

GENERAL INFORMATION

All electrical connections must be in accordance with all ordinances, Local and the U.S. National Electrical Codes (NEC). These fixtures are intended for mounting to a standard 4" metal octagon outlet box.

The box must be directly supported by the building structure and U.L. Recognized.

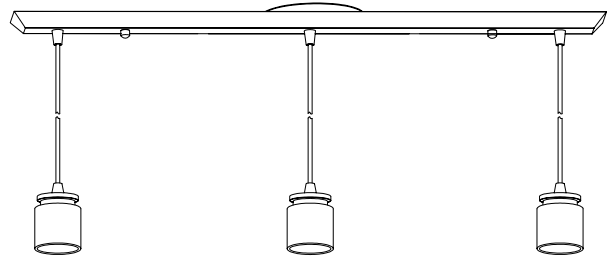

COLLECTION

Trinity

APPLICATION

Ceiling Fixture

MODEL NO.

52023FC

WHAT WE PROVIDE

- Finial
- Mounting Hardware
- Fixture

WHAT YOU NEED

- Screwdriver
- Wire Cutters
- Wiring Supplies as Specified by Electrical Code
- 3 x 60W A-19 Bulbs

STEP BY STEP INSTRUCTIONS

Before starting your installation disconnect the Power by turning off the Circuit Breaker or by removing the fuse at the fuse box. Just turning the light off at the light switch is not sufficient to prevent electrical shock.

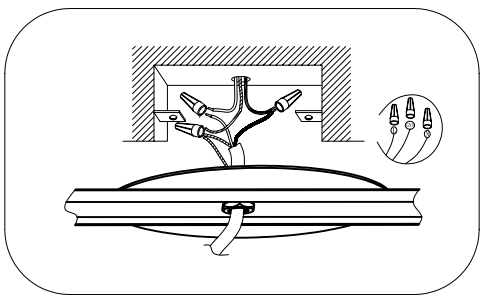

1

CONNECT THE WIRES

Thread the fixture wires through the hole in the J-box cover. Connect the black fixture wire to the black supply wire and the white fixture wire to the white supply wire. Tightly wrap the fixture ground wire together with the ground wire from the J-Box terminal (or the ground wire in the J-Box). Secure all connections with the supplied wire nuts and UL listed electric tape. Tuck all wires carefully into the J-Box.

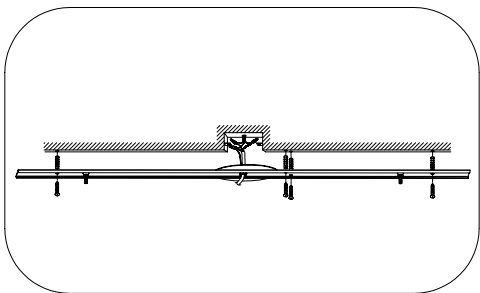

2

MOUNT THE BACK PLATE

Position the J-box cover over the J-box. Secure the back plate to the ceiling with the supplied sheet metal screws.

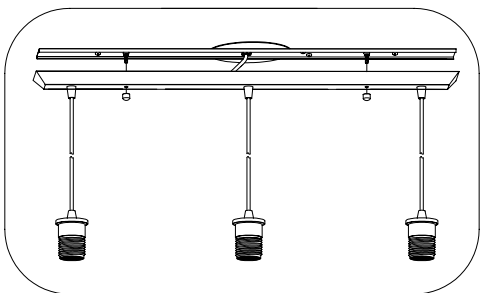

3

MOUNT THE FRONT PLATE

Let the two fixed holes on the front plate sleeve into the screws on the back plate, then use supplied finial fix the front plate after it close to the wall.

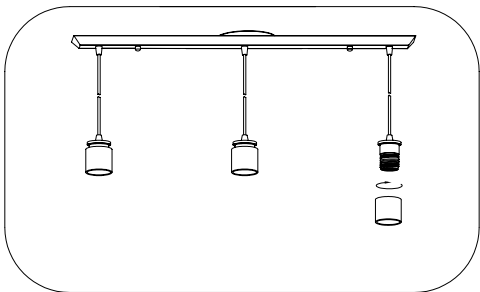

4

ATTACH THE SOCKET RING (OR GLASS SHADE -NOT INCLUDED)

Install the socket ring on to fixture as figure shows.
(if you need the shade, please use this socket ring to fix the shade on the fixture)

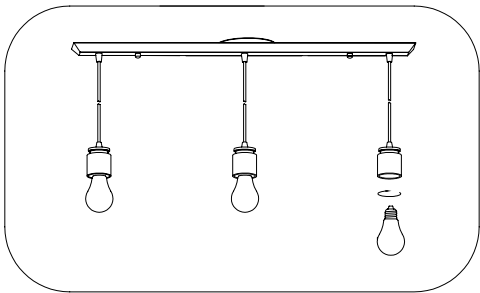

5

INSERT THE BULB

Insert the bulb.
MAXIMUM WATTAGE 60W.
DO NOT EXCEED THE RECOMMENDED WATTAGE AS STATED ON THE WARNING LABEL AND INSTRUCTION SHEETS.

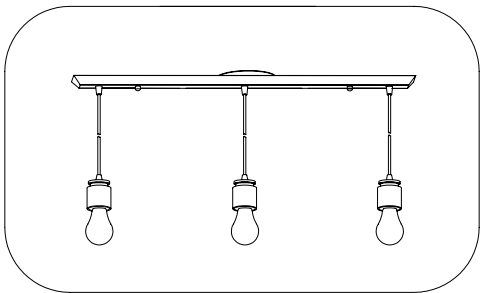

6

RESTORE THE ELECTRICITY AND CHECK THE

OPERATION OF YOUR NEW ACCESS FIXTURE

