

SV FITTINGS

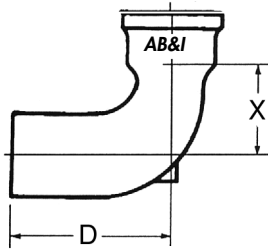

QUARTER BEND, REDUCING

Part No.	Size	X	D	Wt.
000747	4x2"	3-1/4	7	7

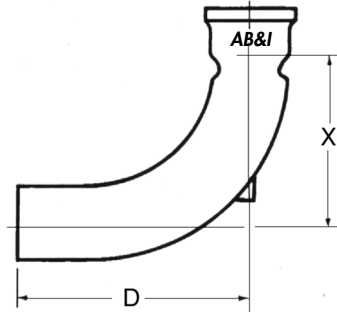

LONG SWEEP BEND, REDUCING

Part No.	Size	X	D	Wt.
001188	3x2"	9	12	11
001195	4x3	9-1/2	13	13

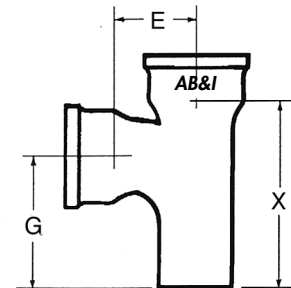

SANTEE

Part No.	Size	X	E	G	Wt.
001287	2"	8	2-3/4	6-1/4	7
001294	3x2	9	4	7	11
001300	3	10	4	7-1/2	11
001317	4x2	9	4-1/2	7	13
001324	4x3	10	4-1/2	7-1/2	15
001331	4	11	4-1/2	8	17
001348	5x4	11	5	8	18
001355	5	12	5	8-1/2	19
001362	6x2	9	5-1/2	7	17
001379	6x3	10	5-1/2	7-1/2	19
001386	6x4	11	5-1/2	8	24
001393	6	13	5-1/2	9	29
001409	8x4	13	6-1/2	9-3/4	38
001416	8x6	15	6-1/2	10-3/4	40
001423	8	17	6-5/8	11-3/4	49
001430	10x4	13	7-1/2	9-3/4	50
001447	10x6	15	7-1/2	10-3/4	55
001454	10x8	17	7-5/8	11-3/4	68
001461	10	19	7-5/8	12-3/4	78
001478	12x6	16-1/2	8-1/2	12	80
001485	12x8	18-1/2	8-5/8	13	111
001492	12x10	20-1/2	8-5/8	14	115
001508	12	22-1/2	8-3/4	15	113
001553	15	25-1/2	10-1/4	16-1/2	245

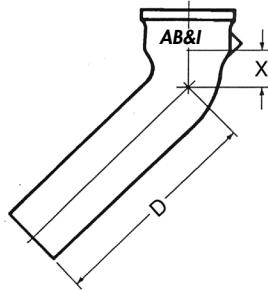

LONG EIGHTH BEND

Part No.	Size	X	D	Wt.
000976	2-18	1-1/2	18	8
000990	3-18	1-15/16	18	12
001010	4-18	2-3/16	18	19

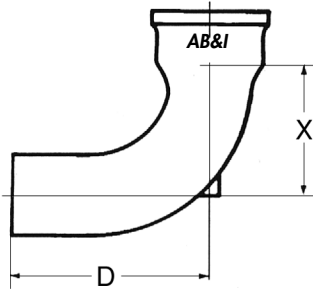

SHORT SWEEP BEND

Part No.	Size	X	D	Wt.
001102	2"	5-1/4	8	6
001119	3	6	9	10
001126	4	6-1/2	10	14
001133	5	7	10-1/2	16
001140	6	7-1/2	11	25
001157	8	8-5/8	13-1/2	48
001164	10	9-5/8	14-1/2	78

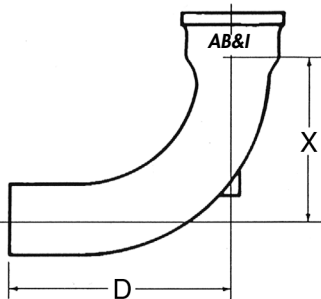

LONG SWEEP BEND

Part No.	Size	X	D	Wt.
001041	2"	8-1/4	11	8
001058	3	9	12	11
001065	4	9-1/2	13	20
001072	5	10	13-1/2	20
001089	6	10-1/2	14	30
001096	8	11-5/8	16-1/2	54

**All AB&I Cast Iron
DWV Products Are
100% Made In America**

TO ORDER CALL TOLL FREE OAKLAND 1-800-GOT-IRON