

SV FITTINGS

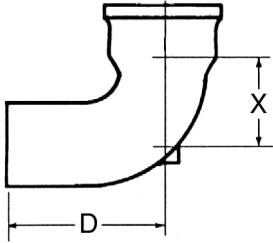

QUARTER BEND

Part No.	Size	X	D	Wt.
000341	2"	3-1/4	6	5
000358	3	4	7	8
000365	4	4-1/2	8	13
000372	5	5	8-1/2	17
000389	6	5-1/2	9	23
000396	8	6-5/8	11-1/2	41
000402	10	7-5/8	12-1/2	59
000419	12	8-3/4	15	79
000426	15	10-1/4	16-1/2	218

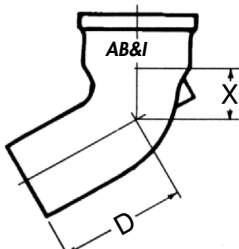

SIXTH BEND

Part No.	Size	X	D	Wt.
000464	2"	2	4-3/4	4
000471	3	2-1/2	5-1/2	6
000488	4	2-13/16	6-5/16	10
000501	10	4-11/16	9-9/16	44

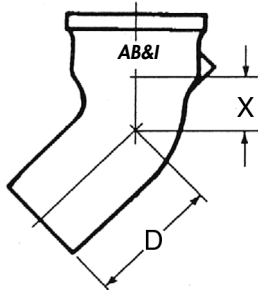

EIGHTH BEND

Part No.	Size	X	D	Wt.
000518	2"	1-1/2	4-1/4	4
000525	3	1-15/16	4-15/16	7
000532	4	2-3/16	5-11/16	10
000549	5	2-3/8	5-7/8	11
000556	6	2-9/16	6-1/16	18
000563	8	3-1/8	8	34
000570	10	3-1/2	8-3/8	50
000587	12	4-1/16	10-5/16	69
000594	15	4-11/16	10-15/16	144

AB&I is your full-line supplier for both quality no-hub and SV hub & spigot cast iron soil pipe and fittings

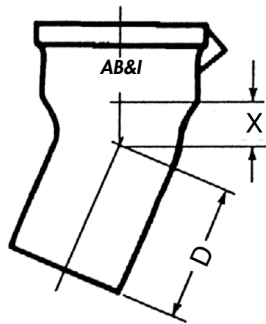

SIXTEENTH BEND

Part No.	Size	X	D	Wt.
000600	2"	7/8	3-5/8	3
000617	3	1-3/16	4-3/16	6
000624	4	1-5/16	4-13/16	9
000631	5	1-3/8	4-7/8	9
000648	6	1-1/2	5	12
000655	8	1-13/16	6-11/16	25
000662	10	1-13/16	6-7/8	39
000679	12	2-3/8	8-5/8	56
000686	15	2-5/8	8-7/8	78

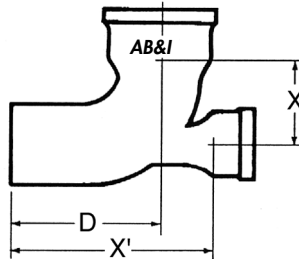

**QUARTER BEND
w/ Low Heel Inlet**

Part No.	Size	X	X'	D	Wt.
000716	3-2	4	9	7	9
000723	4-2	4-1/2	10-1/2	8	13

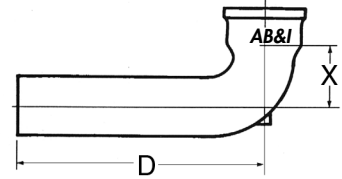

LONG QUARTER BEND

Part No.	Size	X	D	Wt.
000808	2-18	3-1/4	18	8
000839	4-12	4-1/2	12	13
000860	4-18	4-1/2	18	17

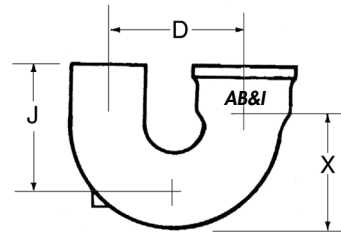

SINGLE HUB RETURN BEND

Part No.	Size	X	D	J	Wt.
001027	3"	6	7	7	9
001034	4	6-3/4	8	7-1/2	13

TO ORDER CALL TOLL FREE OAKLAND 1-800-GOT-IRON